



Drainage pump with open impeller for pumping liquids with suspended solids. Characterized by high head.



Construction features

Pump body cast iron

Shell, motor cover, base support stainless steel



Impeller brass

Mechanical seal double seal with oil barrier: silicon carbide on pump side, sealing ring on motor side

Motor shaft stainless steel AISI 430

Free passage Ø max 10 mm

Max submergence max 5 m

Liquid temperature 0 - 40 °C

Cable H05 RN8F, 10 m

G float switch

Motor

3~ 3x400V-50Hz

2 Poles induction motor 1~ 1x230V-50Hz
(with thermal protection)

Insulation class F

Protection degree IPX8

TYPE	LOTS			
	TRUCK		CONTAINER	
	PALLET (cm)	N° pumps	PALLET (cm)	N° pumps
DH	80×120×125	57	80×120×165	76



DH

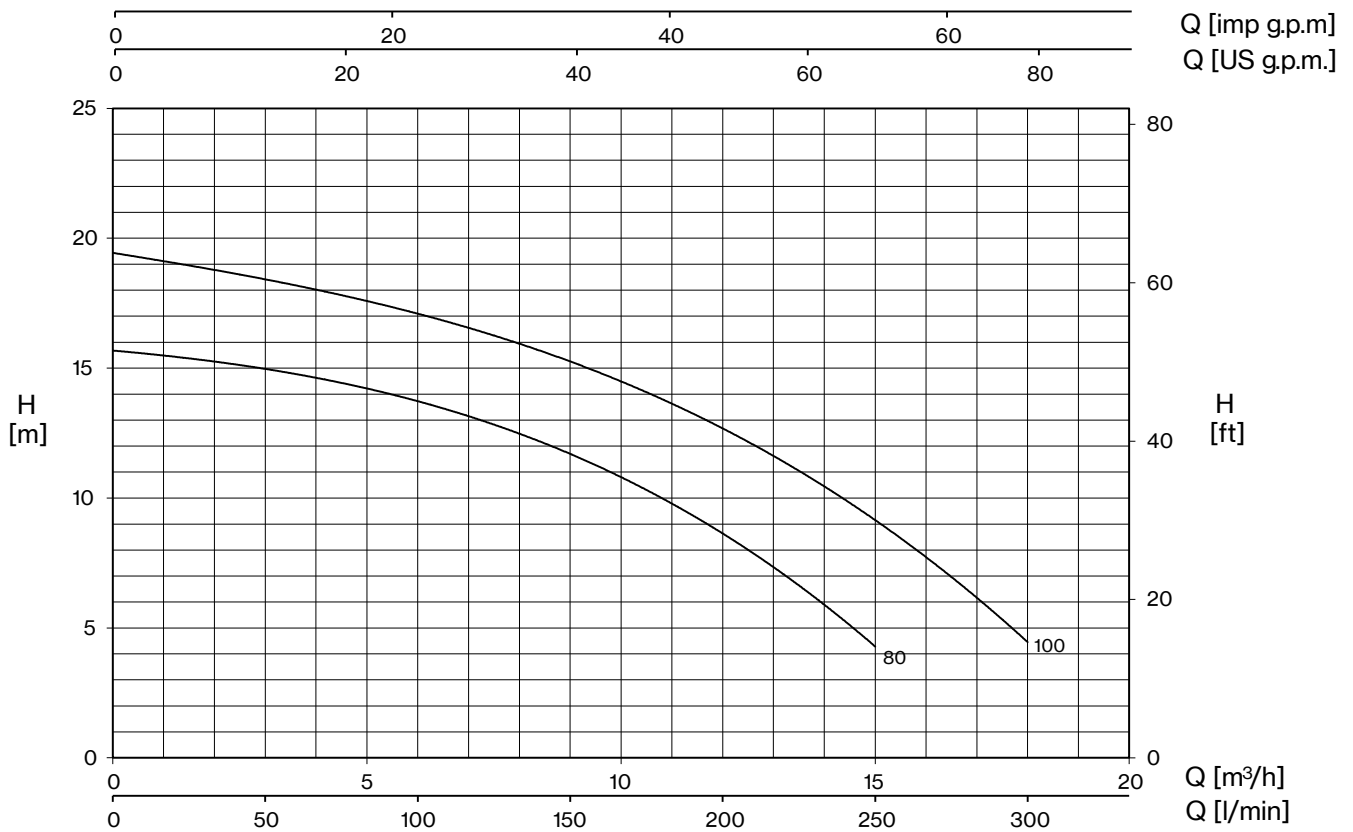

TYPE		W	AMPERE		Q (m³/h - l/min)						
1~	3~		1~	3~	0	3	6	9	12	15	18
			1x230 V 50 Hz	3x400 V 50 Hz	0	50	100	150	200	250	300
H (m)											
DH 80 (G)	DHT 80	980	4,3	2,1	15,7	14,9	13,8	11,7	8,6	4,3	
DH 100 (G)	DHT 100	1370	6,2	2,8	19,4	18,5	17,1	15,2	12,6	9,3	4,4

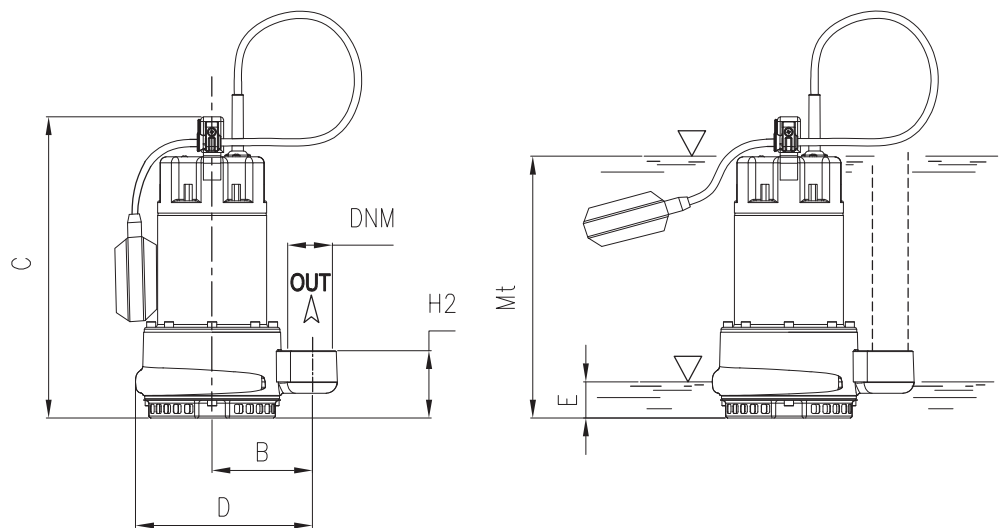

E: maximum emptying level
Mt: minimum liquid level for continuous duty

TYPE	DIMENSIONS (mm)										Kg
	B	C	D	E	H2	Mt	DNM	I	L	M	
DH 80 (G)	105	330	218,5	45	70	190	1" 1/2 G	180	255	380	14,5
DH 100 (G)	105	330	218,5	45	70	190	1" 1/2 G	180	255	380	16

