



END SUCTION CENTRIFUGAL PUMP

INTELLIGENT FLOW FOR GOOD



LEO GROUP PUMP CO., LTD.
LEO GROUP PUMP (ZHEJIANG) CO., LTD.

📍 No.1, 3rd Street, East Industry Center, Wenling, Zhejiang, 317511, P.R.China
🌐 www.leopump.com ✉ export@leopump.com
☎ +86-576-8998 6360 📠 +86-576-8998 9898



Website



Facebook



YouTube

LEO reserves all the right of products modification without prior notification

2023 V2.0

www.leopump.com



0.75kW-7.5kW

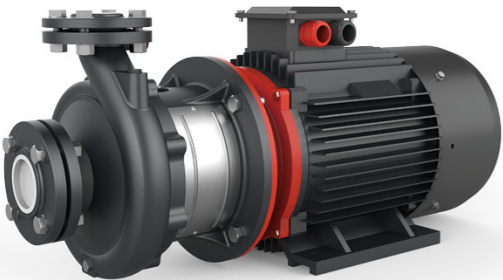

9.2kW-55kW

Application

- Circulation and transfer of clean, chemically non-aggressive water and other liquids
- Water supply & irrigation
- Water circulation in air conditioning systems
- Fire fighting system

Operating Conditions

- Delivery: up to 210 m³/h
- Head: up to 95 m
- Liquid temperature: Standard -10°C to 85°C
- Maximum operating pressure: 12 bar (PN12)
- Anti-clockwise rotation when facing pump's suction port
- Impeller: AISI304 , HT200
- Mechanical seal in compliance with DIN 24960
- Lubricated by internal recirculating pumped liquid
- Counter flange available on request

Motor

- Closed construction, external ventilation
- Insulation class: F
- Protection class: IP54
- Performance in compliance with CEI 2-3 (IEC 34.1)
- Max.ambient temperature: +40°C
- Overload protection
- For model that ≥9.2kw: Equipped with IE2 motor, IE3 motor available on request.
- For model that ≤7.5kw, the following 4 models can equipped with IE3 motor. (XST40-160/30、XST40-160/40、XST50-160/55、XST50-160/75)

Identification Codes

XST m 32 - 125 K / 11

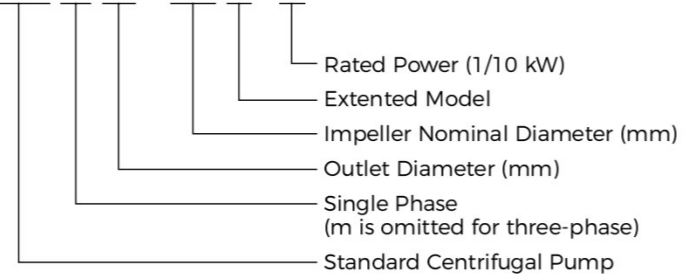

Construction Features

- Single- impeller centrifugal pump featuring axial intake and radial discharge
- Inlet and outlet DN in compliance with EN 733 (ex DIN 24255) and UNI 7467
- Flanges in compliance with UNI 2236 and DIN 2532
- Rear entry (impeller, motor can be extracted without disconnecting the pump body from the pipes)

Materials Table

Exploded diagram of 7.5 kW and below

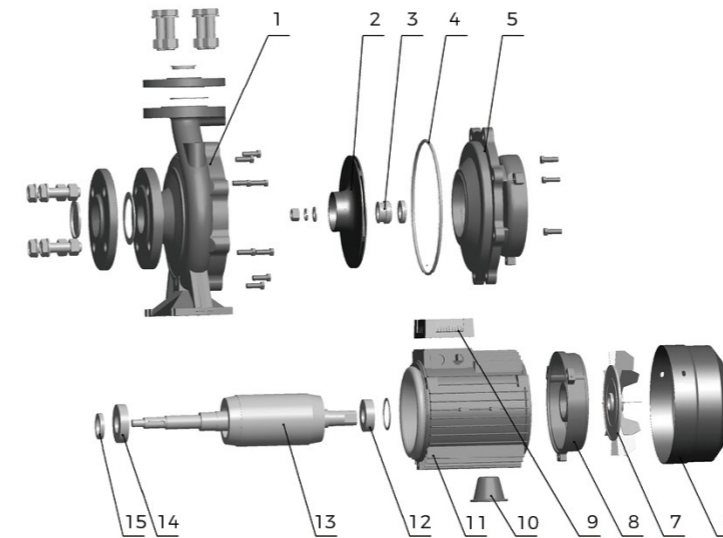

No.	Part	Material
1	Pump body	HT200
2	Impeller	HT200 / 06Cr19Ni10
3	Mechanical seal	
4	O-ring	NBR
5	Connection body	HT200
6	Wind cover	08F
7	Fan	PP
8	Back cover	ZL102
9	Cover box	ABS
10	Brace	HT200
11	Stator	
12	Bearing	
13	Rotor	
14	Bearing	
15	Skeleton seal	

Exploded diagram above 7.5 kW

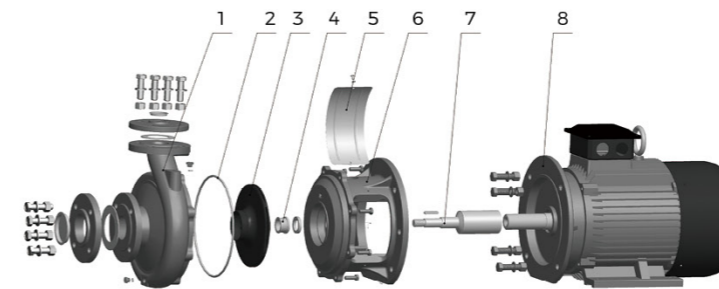

No.	Part	Material
1	Pump body	HT200
2	O-ring	NBR
3	Impeller	HT200 / 06Cr19Ni10
4	Machinery Seal	
5	Guard plate	06Cr19Ni10
6	Connection body	HT200
7	Pump shaft	45/06Cr19Ni10
8	Motor	

Performance Parameter

Model	Power		Q(m³/h)	Q(l/min)																			
	kW	HP		0	100	150	250	300	400	450	600	700	800	900	1200	1400	1500	1800	2000	2300	3000	3500	
32-125/7*	0.75	1		17.5	16.7	15	12	9															
32-125/11*	1.1	1.5		22	21	20.2	17	15	9														
32-160/15*	1.5	2		24	23.7	22.5	19.5	16.2															
32-160/22*	2.2	3		31	29.6	29	25.5	22.5	15														
32-160/30*	3	4		34.5	33.5	33	29	26.5	20	16.5													
32-200/30*	3	4		43.2	42	40.5	35.2	32.2	24.6	19.8													
32-200/40*	4	5.5		52	50.5	50	45	41.9	35	30.3													
32-250/55**	5.5	7.5		79	74.7	71.8	63	56	37.5														
32-250/75**	7.5	10		95	92	89	82	75	57.8	48													
40-125/11	1.1	1.5		14.7			13	11.5	10.1														
40-125/15	1.5	2		18.1			17	15	13.9														
40-125/22	2.2	3		24.5			23.2	21.5	20.2	16	12												
40-160/30	3	4		31.8			29	27.5	26.3	21.5	17.5												
40-160/40	4	5.5		38			36	34	33	28.5	25	20.1											
40-200/55*	5.5	7.5		44			42	40	38	32	27												
40-200/75*	7.5	10		55			52	49	48	42	37	32											
40-250/92*	9.2	12.5		64			59	56.5	55	49.5	45	39.8											
40-250/110*	11	15		72			67.5	65	63.5	57.5	52.2	47											
40-250/150*	15	20		82			79	77.3	76.5	71	66	60.5	54.8										
50-125/22	2.2	3		17						15.4	14	12.8	11.5										
50-125/30	3	4		20						18.8	18	17	15.6										
50-125/40	4	5.5		24						23.1	22.6	21.5	20.3	15.8									
50-160/55	5.5	7.5		32						30.6	30	28	26.6	20.5									
50-160/75	7.5	10		40						38	37	36	34.4	29									
50-200/92*	9.2	12.5		50.5						46.8	45	43	40.9	32.5									
50-200/110*	11	15		57.5						53.5	52	50	47.5	40									
50-250/150*	15	20		68.5						64	63	61.5	59	50	41								
50-250/185*	18.5	25		77						73.2	72	70	68	60.5	51.5								
50-250/220*	22	30		86.3						83	81.5	80	78	70	61								
65-125/40	4	5.5		19								17.3	16.8	14.5	13	11.8							
65-125/55	5.5	7.5		23								21.3	20.9	19	17.5	16.7	13.7						
65-125/75	7.5	10		27								26	25.6	24.5	23	22.5	20	18					
65-160/92	9.2	12.5		33									31.5	30	28	27.1	24	21.5					
65-160/110	11	15		36									34.5	33	31.5	30.8	28	25.5					
65-160/150	15	20		42									41	40	38.5	37.8	35	33					
65-200/150	15	20		45.5									46	43.5	41	39.2	33						
65-200/185	18.5	25		53									53.5	51.2	48.3	47	41.5						
65-200/220	22	30		59									59.5	57.2	54	53	47	43.5					
65-200K/185	18.5	25		41.2										42	41.2	40.6	38.2	36.5	34				
65-200K/220	22	30		48											48	47.5	46	44	41				
65-200K/300	30	40		59.5											59	58.5	58	56.2	54				
65-250/220	22	30		62										61.5	58.2	56.5	54	49	45	36			
65-250/300	30	40		76										75	73	70	69	64	61	54			
65-250/370	37	50		90										88	86	84	82	78	74	68			
80-160/110	11	15		27												27.3	26	24.5	22.5	16			
80-160/150	15	20		32.8												32.5	31.3	30.2	28	22.1	16.7		
80-160/185	18.5	25		39												38	36.8	35.7	33.8	28.8	23.5		
80-200/220	22	30		48												47.5	46	43.5	41	32.5			
80-200/300	30	40		60												59.5	58	57	54.5	47			
80-250/370	37	50		71.5												70.5	67.5	65.5	61.5	49.5	38		
80-250/450	45	61		82												80.5	78.5	76.5	72	62	51		
80-250/550	55	75		95												93.5	91.2	89.8	86.8	77.6	68.3		

*=Stainless steel impeller **=Two-stage stainless steel impeller

Characteristic Curves

XST	Rated speed: 2900r/min	ISO 9906 Annex A
-----	------------------------	------------------

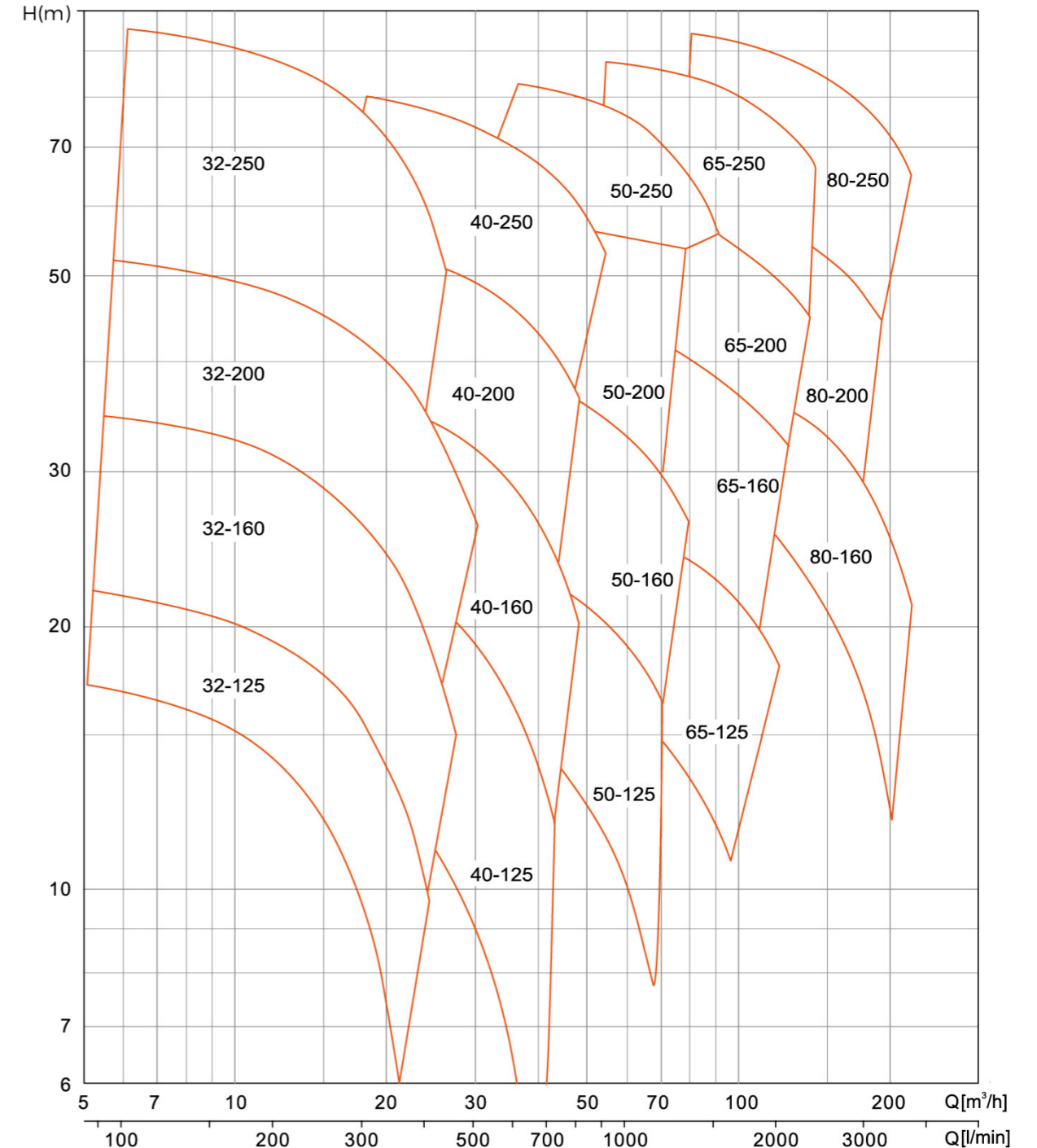

Hydraulic Performance Curves

XST32-125	Rated speed: 2900r/min	ISO 9906 Annex A
-----------	------------------------	------------------

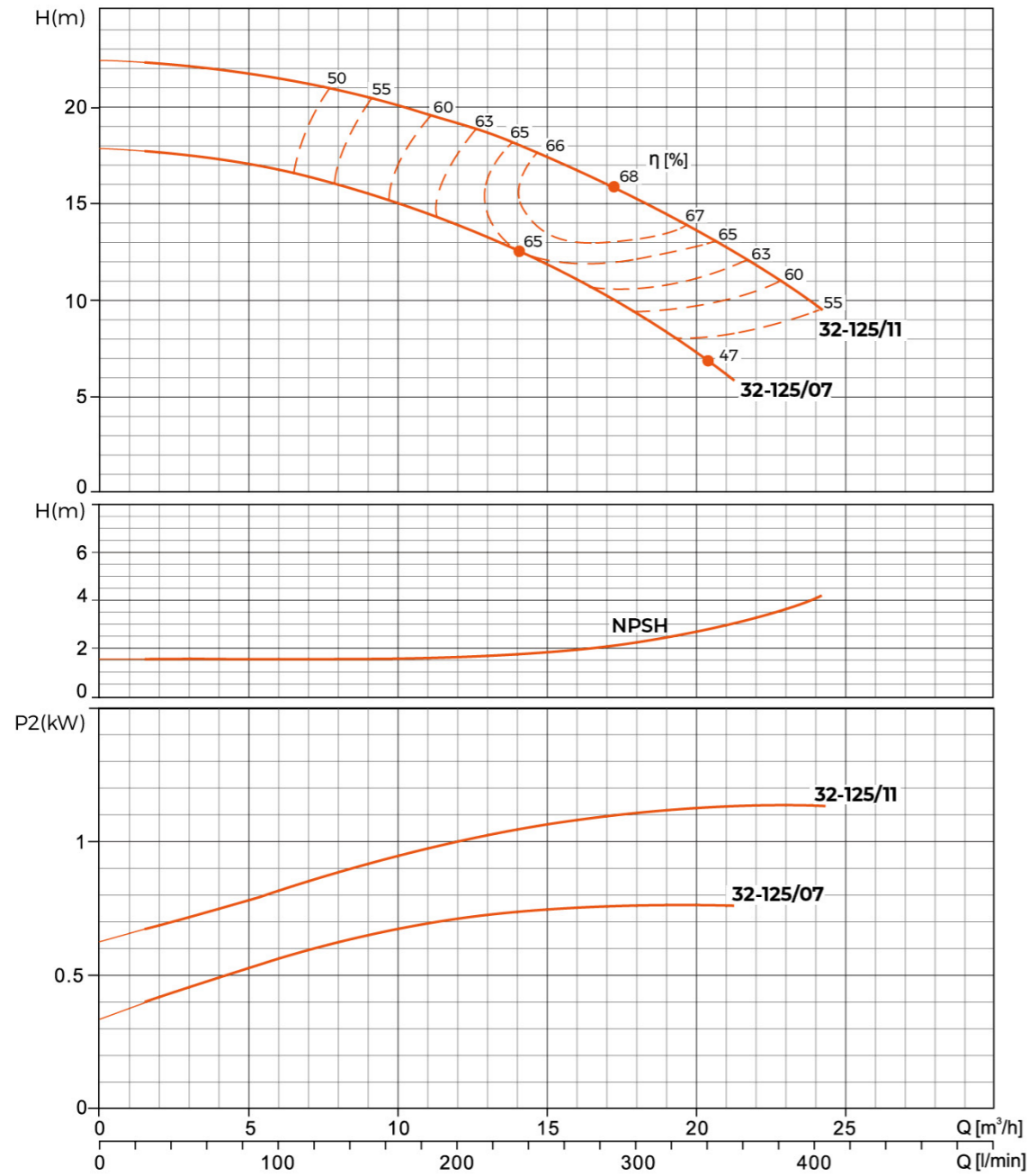

Hydraulic Performance Curves

XST32-160	Rated speed: 2900r/min	ISO 9906 Annex A
-----------	------------------------	------------------

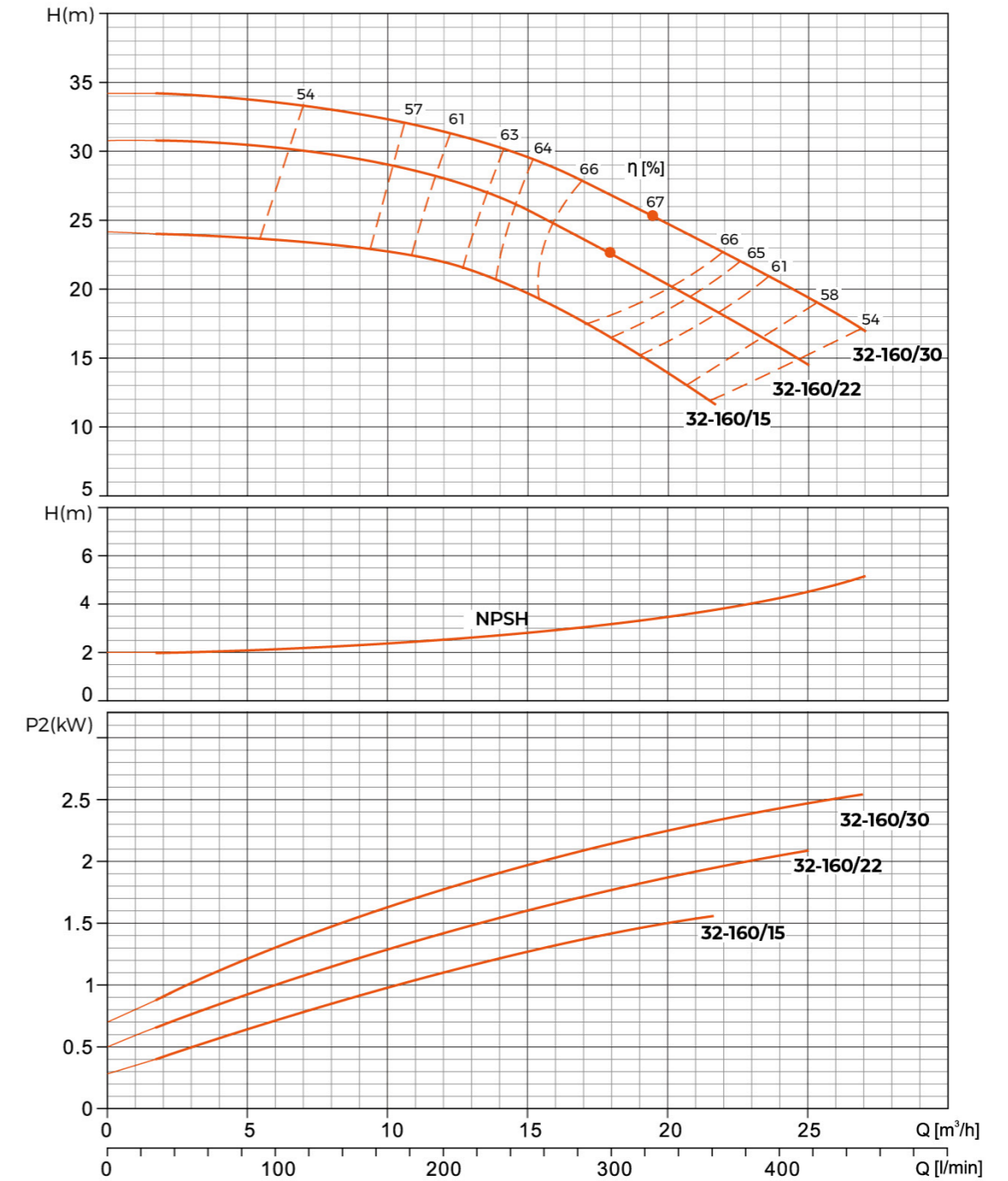

Hydraulic Performance Curves

XST32-200	Rated speed: 2900r/min	ISO 9906 Annex A
-----------	------------------------	------------------

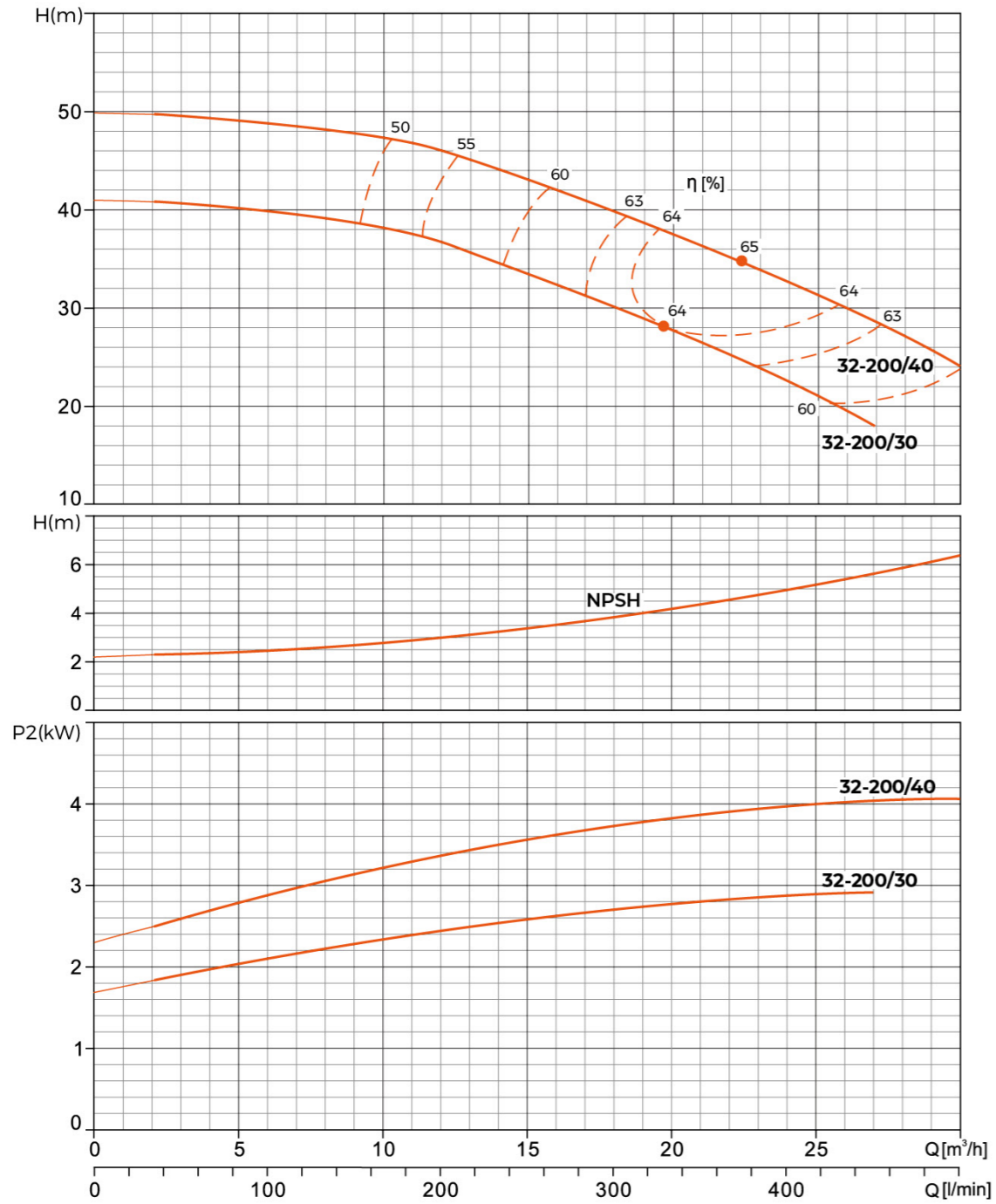

Hydraulic Performance Curves

XST32-250	Rated speed: 2900r/min	ISO 9906 Annex A
-----------	------------------------	------------------

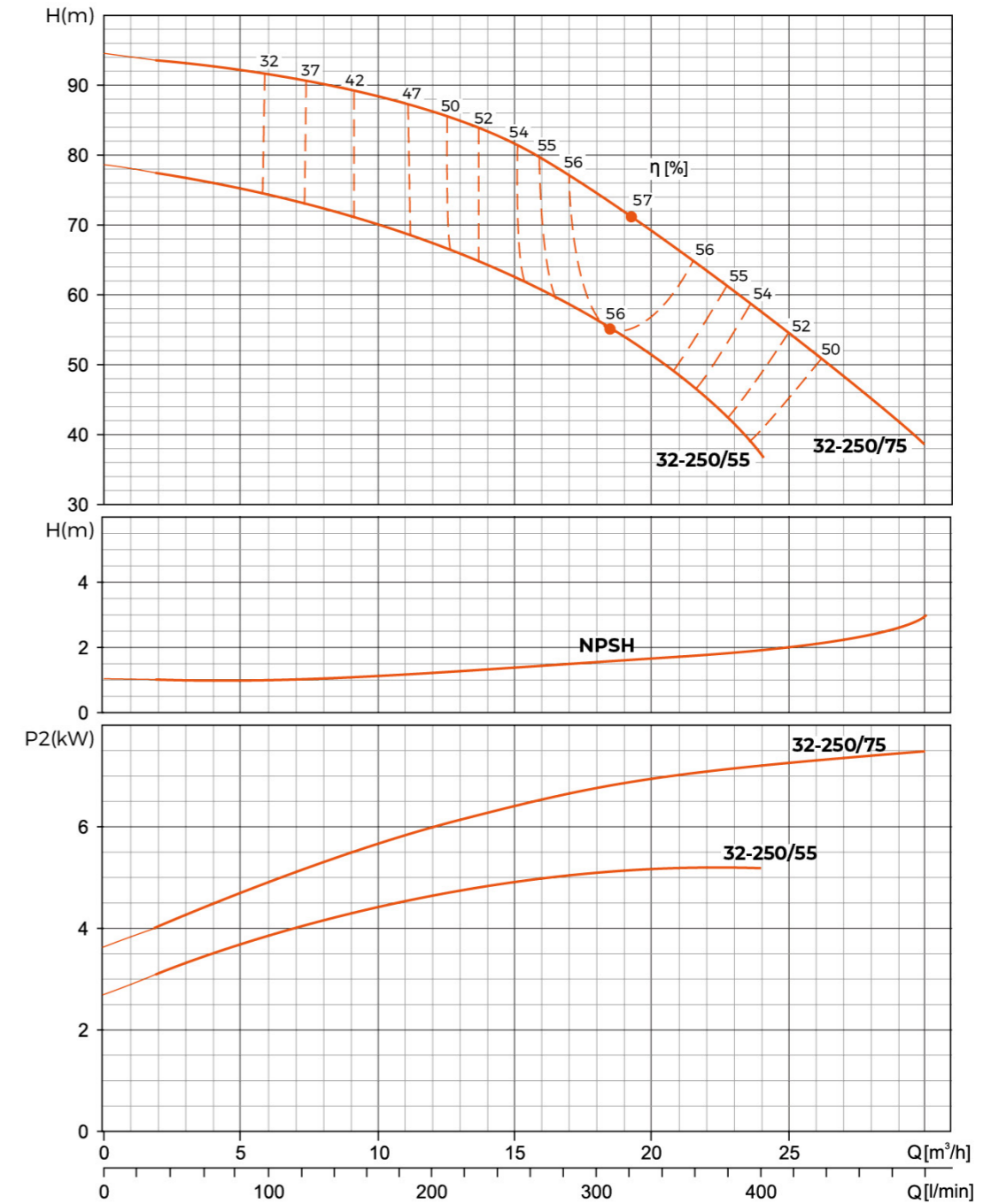

Hydraulic Performance Curves

XST40-125	Rated speed: 2900r/min	ISO 9906 Annex A
-----------	------------------------	------------------

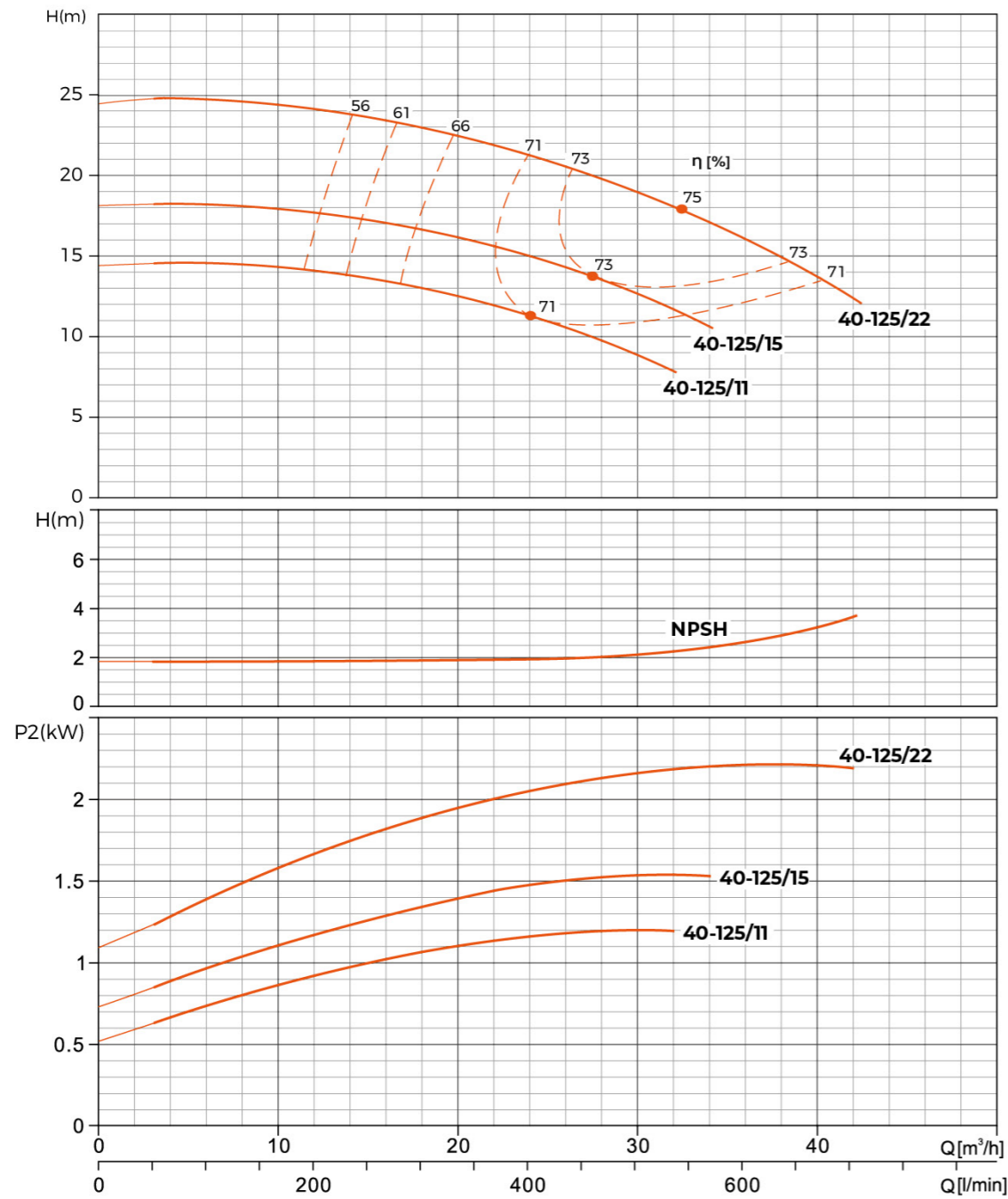

Hydraulic Performance Curves

XST40-160	Rated speed: 2900r/min	ISO 9906 Annex A
-----------	------------------------	------------------

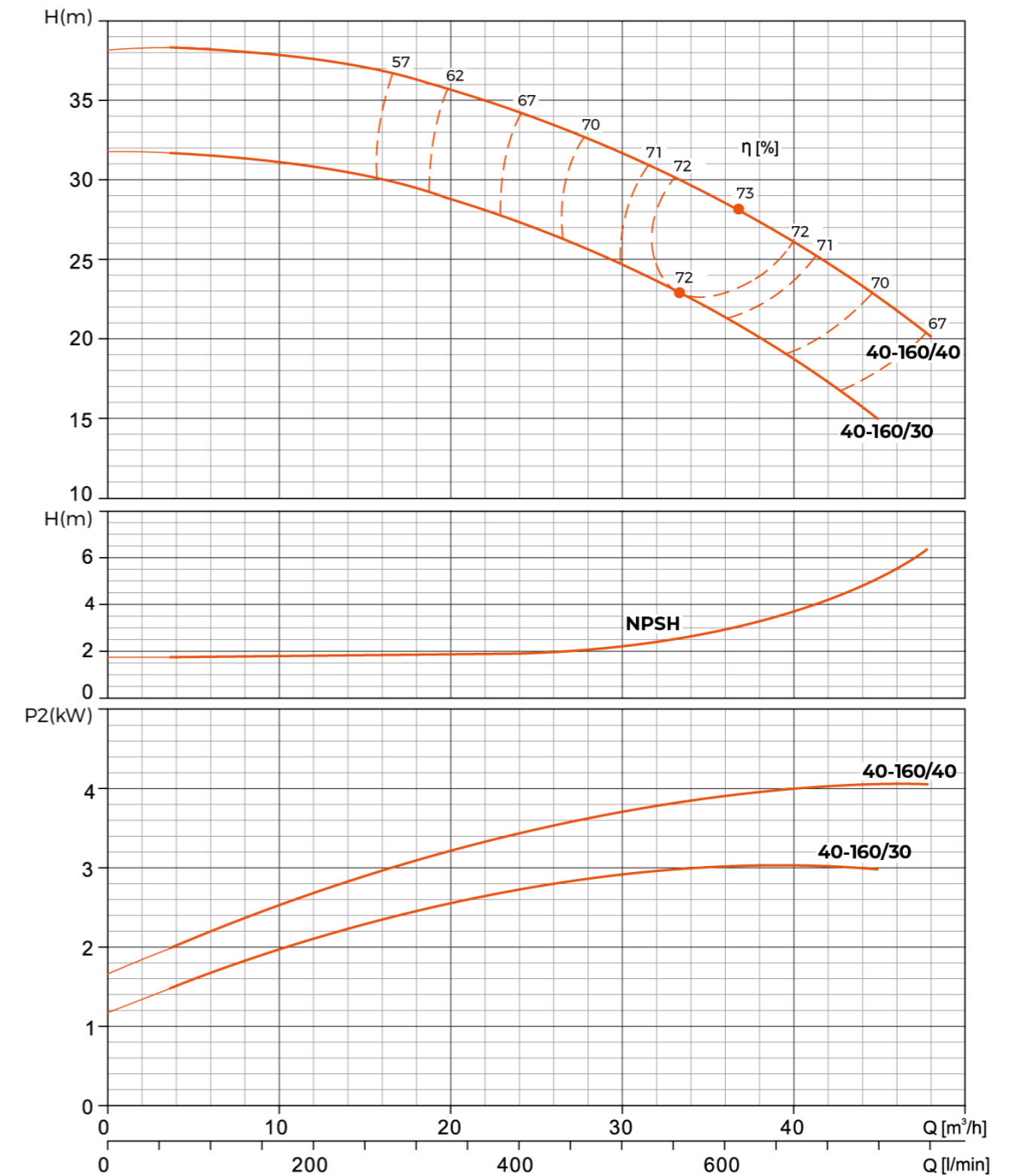

Hydraulic Performance Curves

XST40-200	Rated speed: 2900r/min	ISO 9906 Annex A
-----------	------------------------	------------------

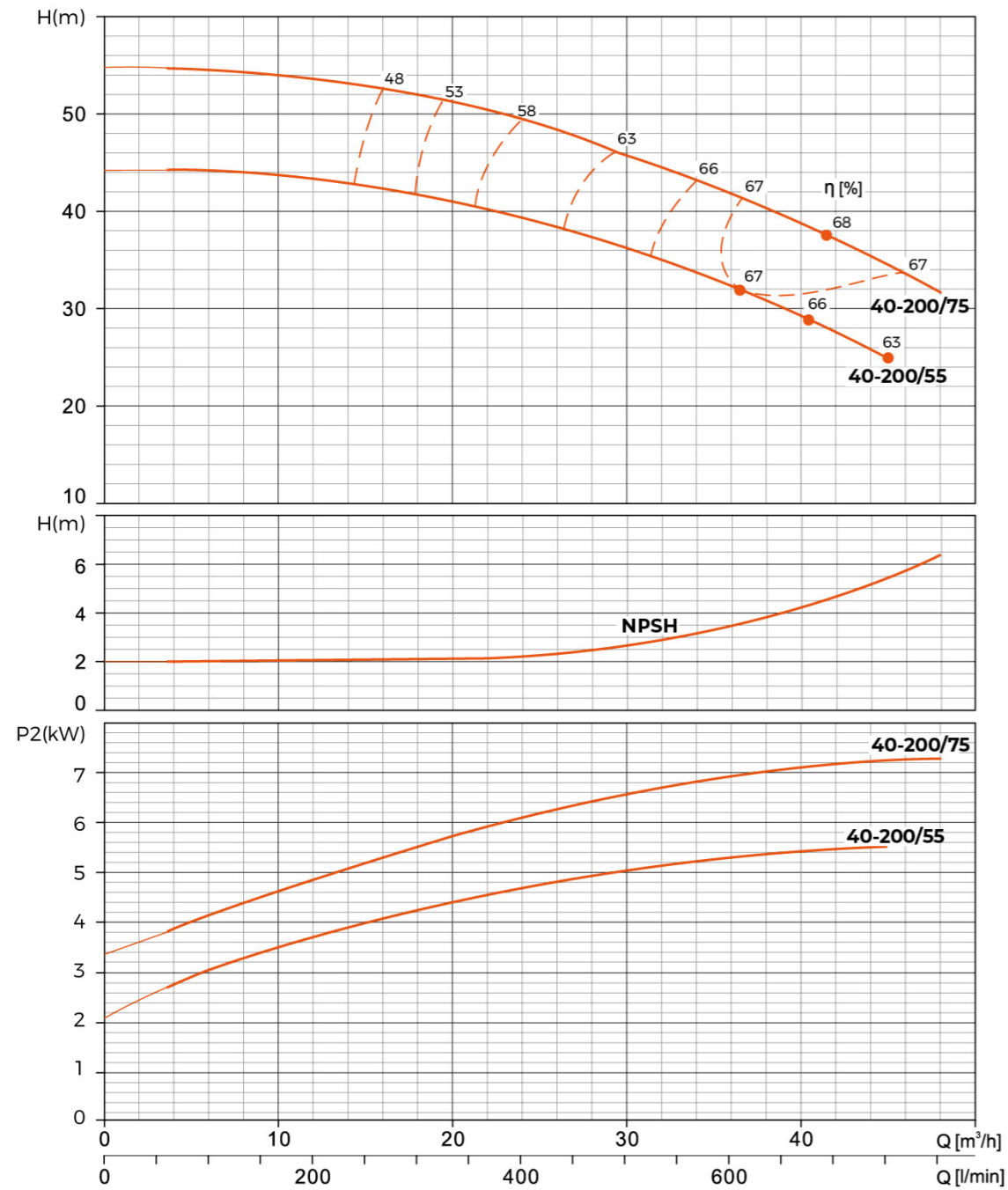

Hydraulic Performance Curves

XST40-250	Rated speed: 2900r/min	ISO 9906 Annex A
-----------	------------------------	------------------

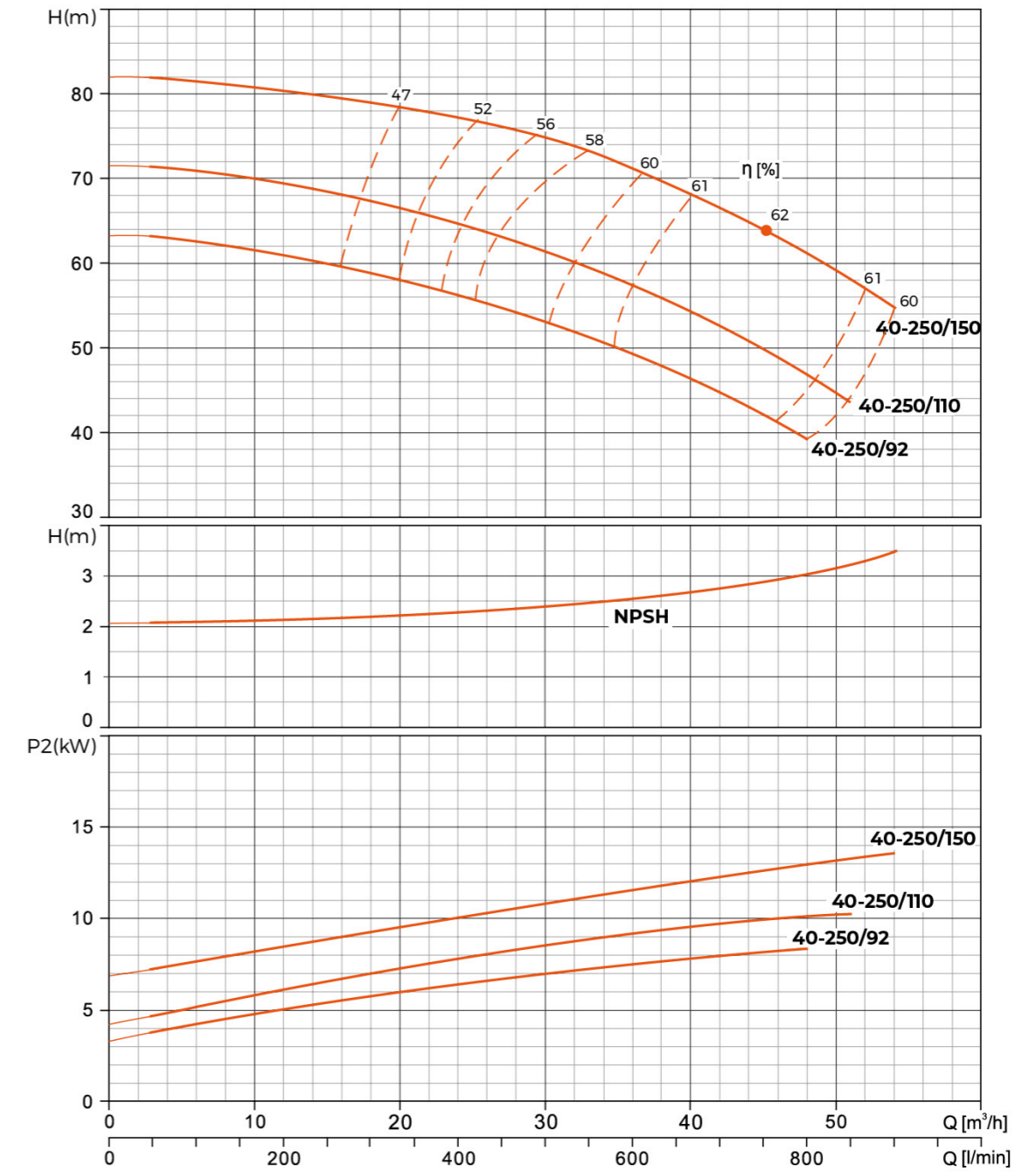

Hydraulic Performance Curves

XST50-125	Rated speed: 2900r/min	ISO 9906 Annex A
-----------	------------------------	------------------

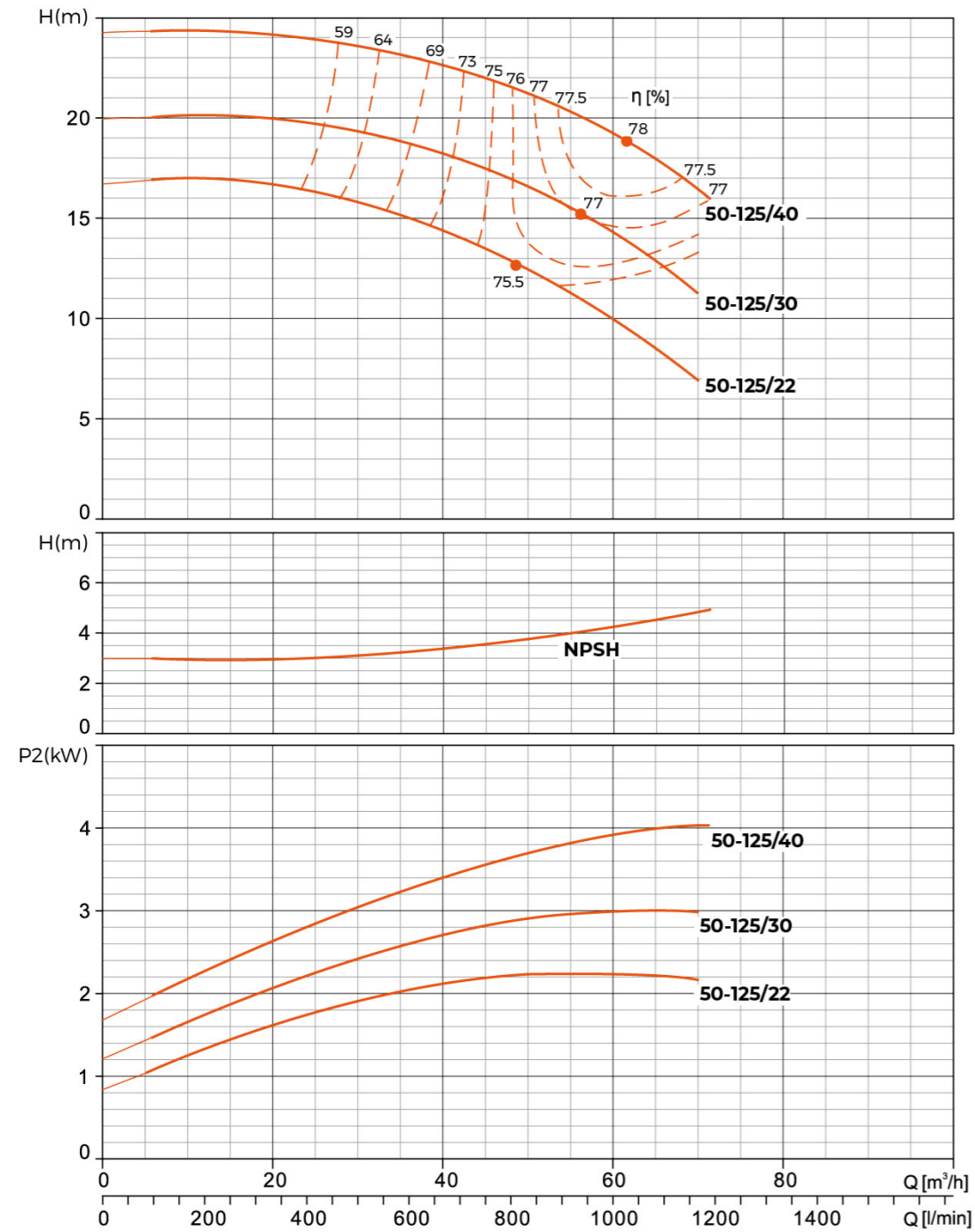

Hydraulic Performance Curves

XST50-160	Rated speed: 2900r/min	ISO 9906 Annex A
-----------	------------------------	------------------

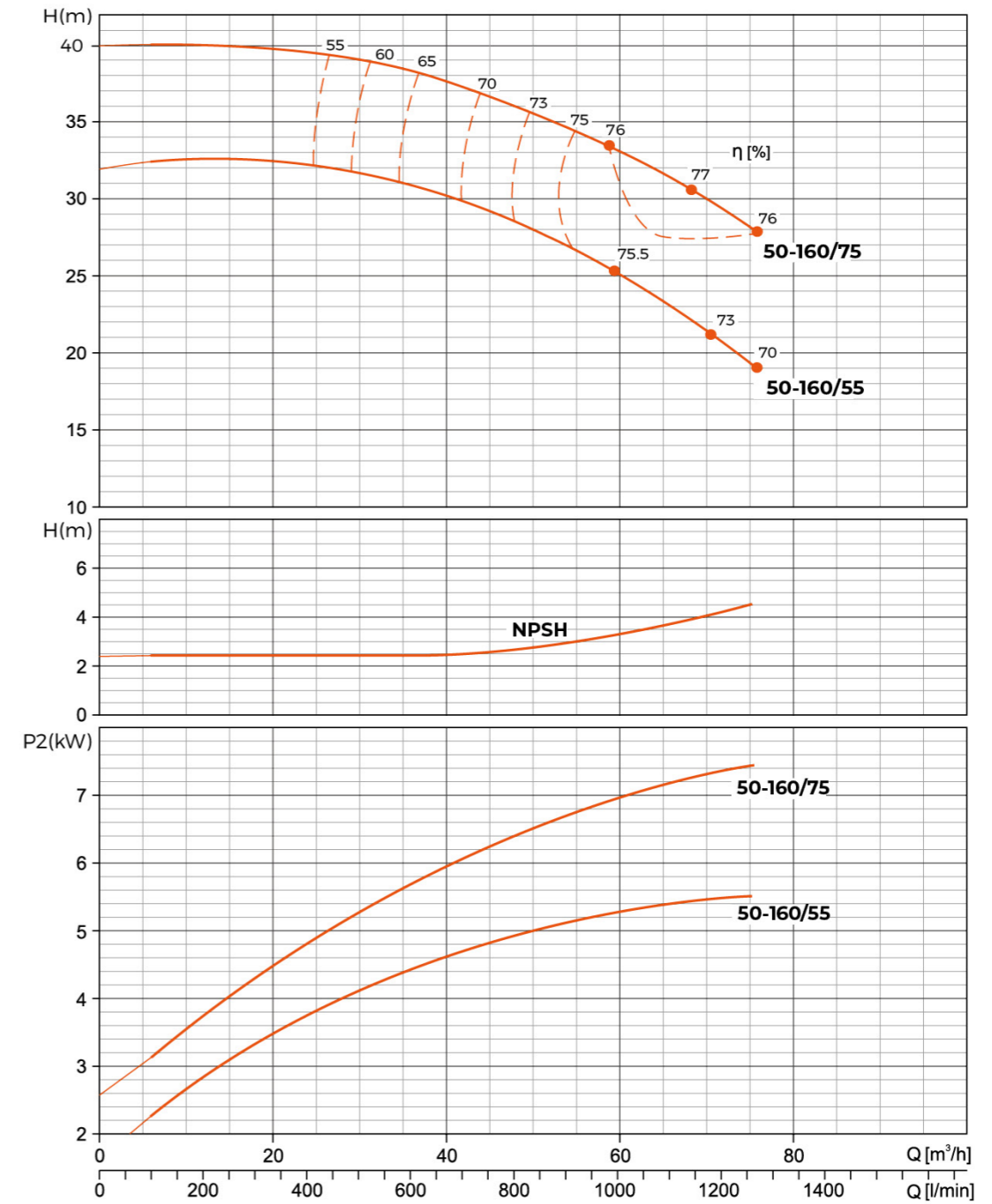

Hydraulic Performance Curves

XST50-200	Rated speed: 2900r/min	ISO 9906 Annex A
-----------	------------------------	------------------

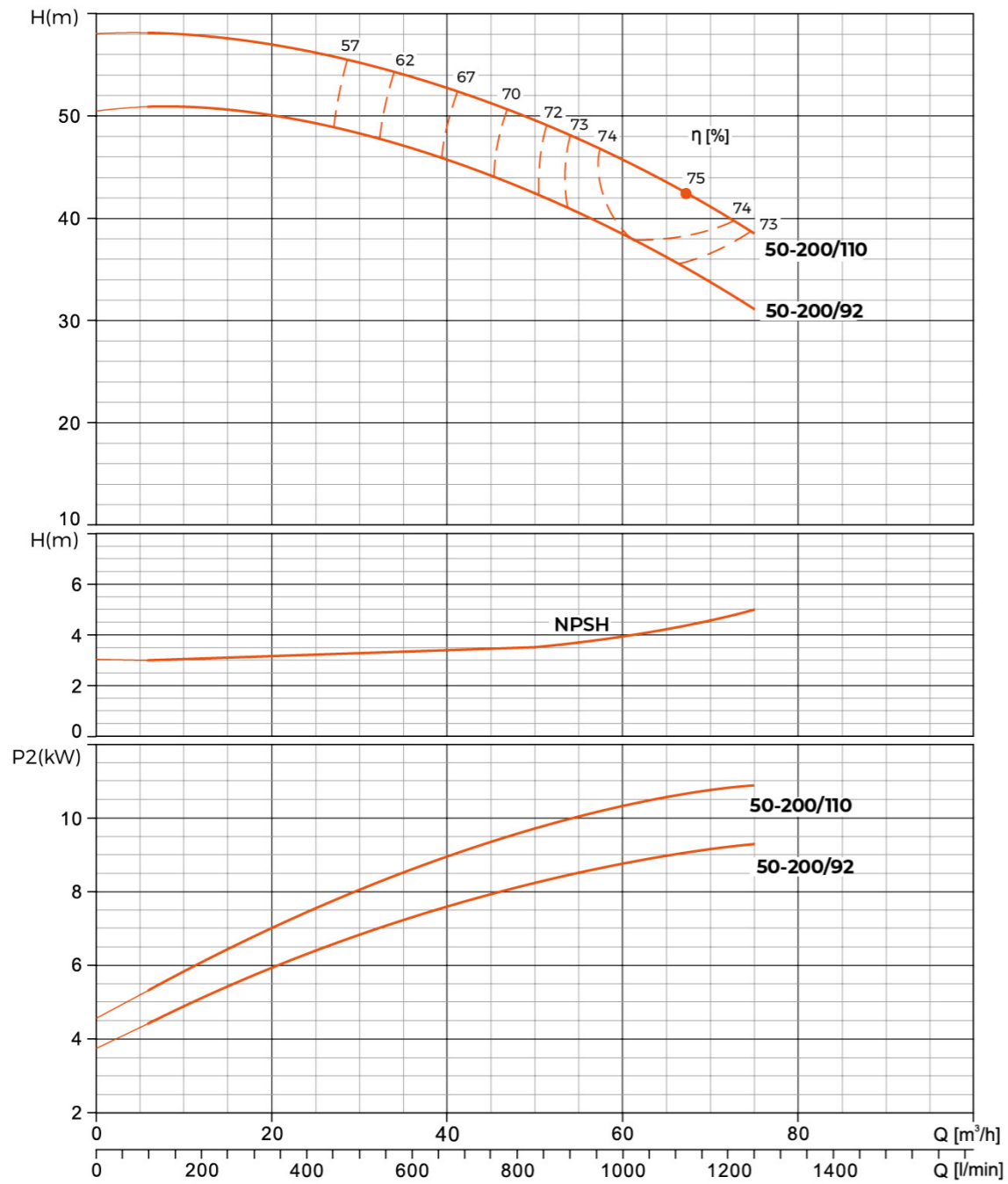

Hydraulic Performance Curves

XST50-250	Rated speed: 2900r/min	ISO 9906 Annex A
-----------	------------------------	------------------

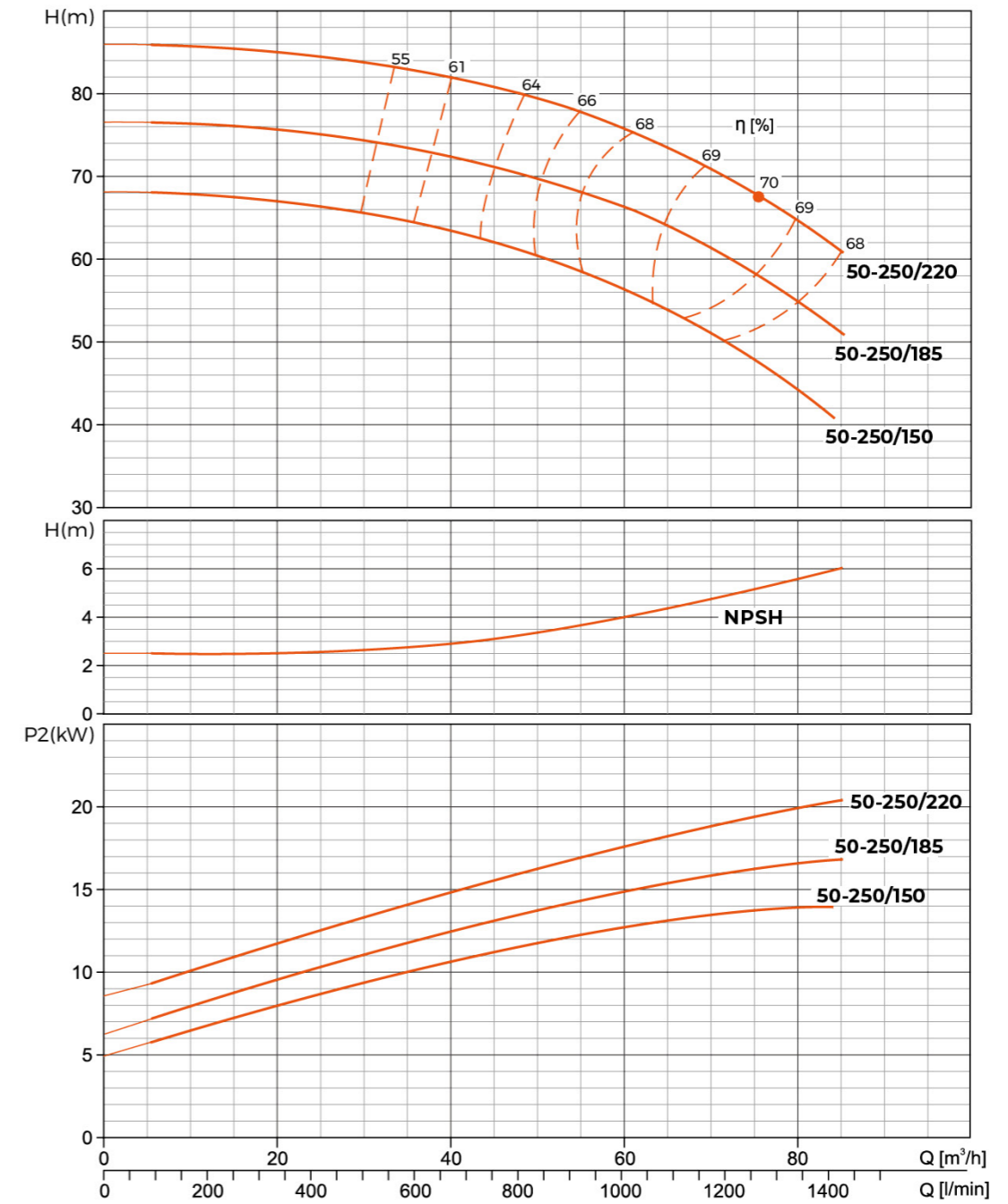

Hydraulic Performance Curves

XST65-125	Rated speed: 2900r/min	ISO 9906 Annex A
-----------	------------------------	------------------

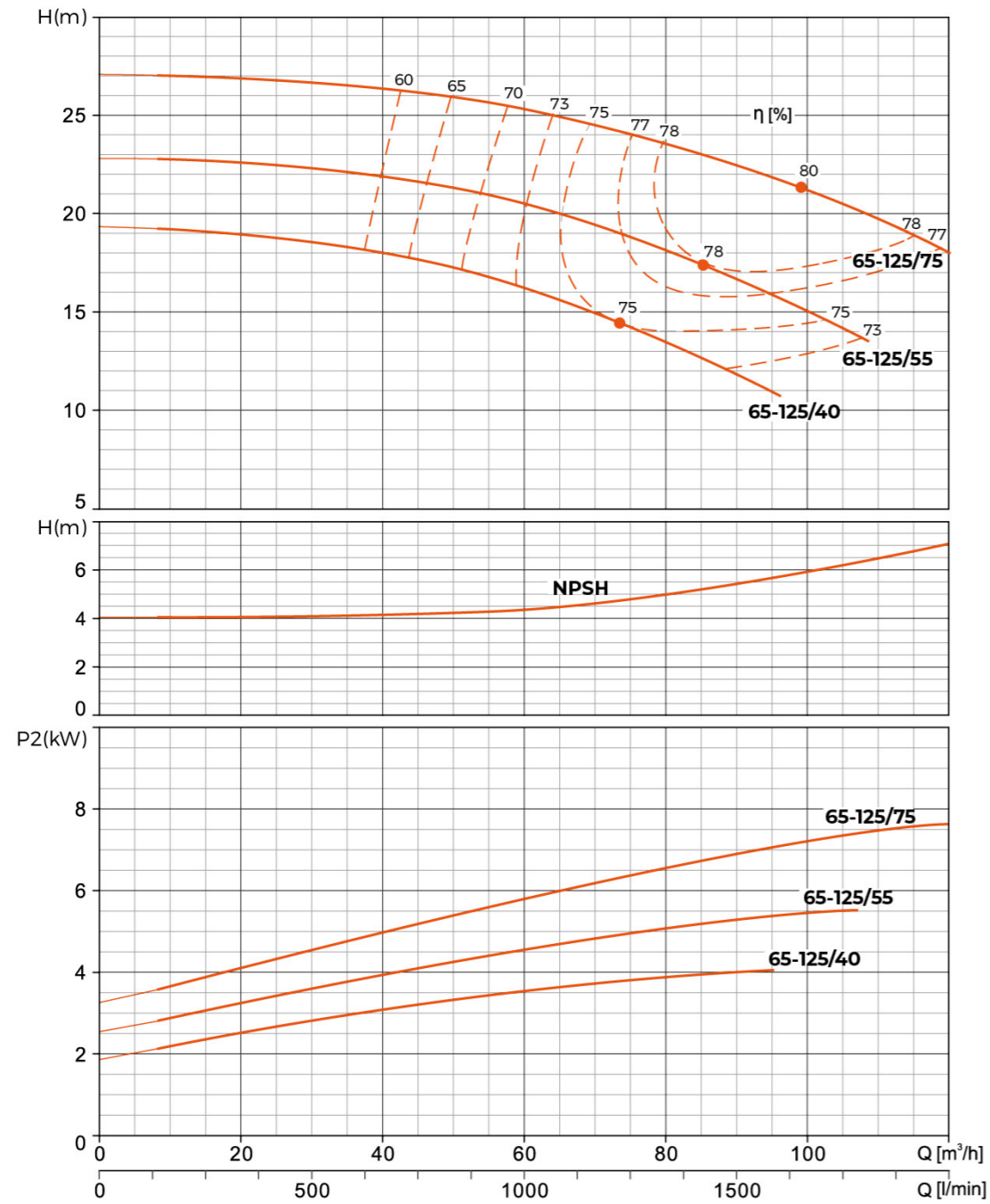

Hydraulic Performance Curves

XST65-160	Rated speed: 2900r/min	ISO 9906 Annex A
-----------	------------------------	------------------

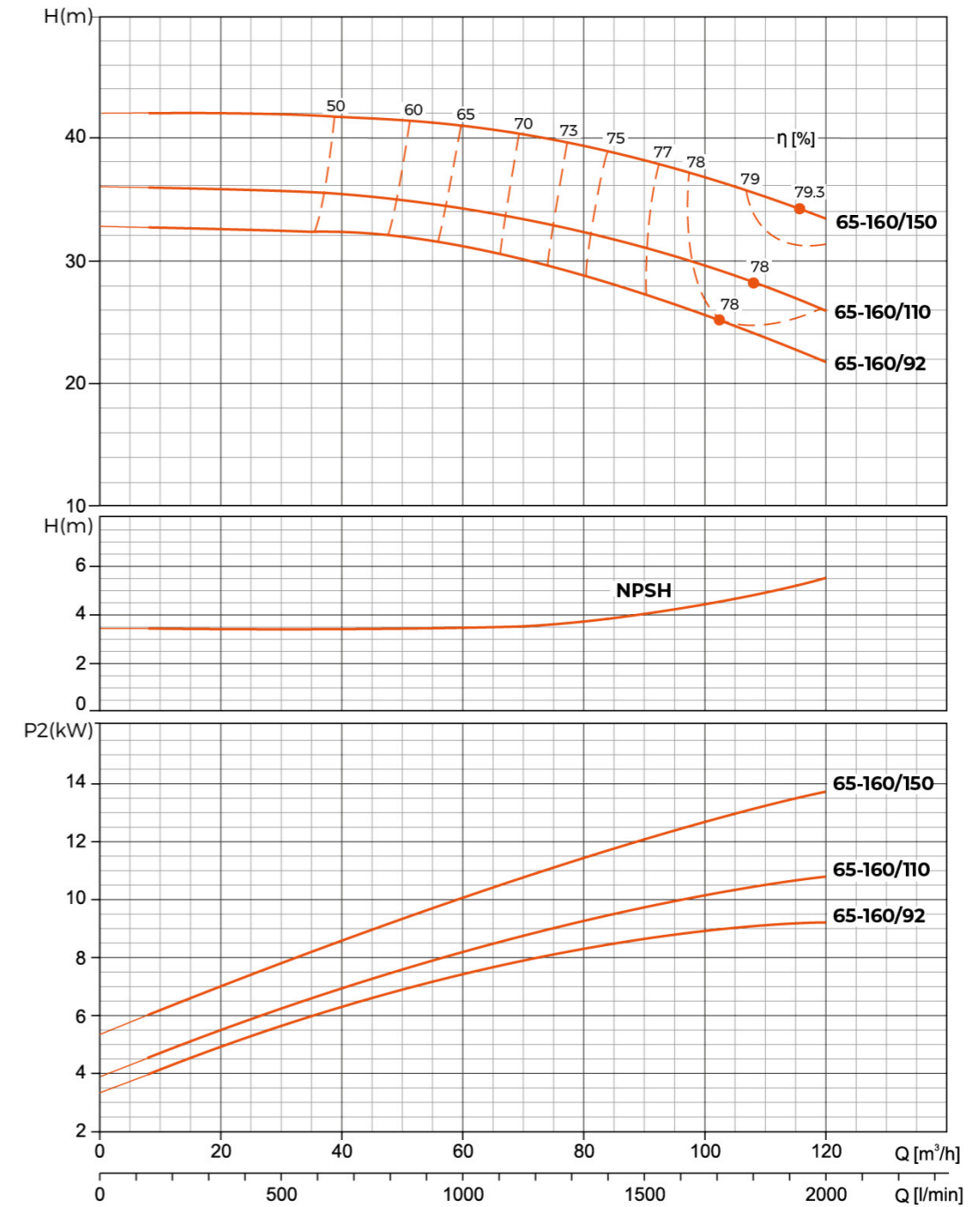

Hydraulic Performance Curves

XST65-200	Rated speed: 2900r/min	ISO 9906 Annex A
-----------	------------------------	------------------

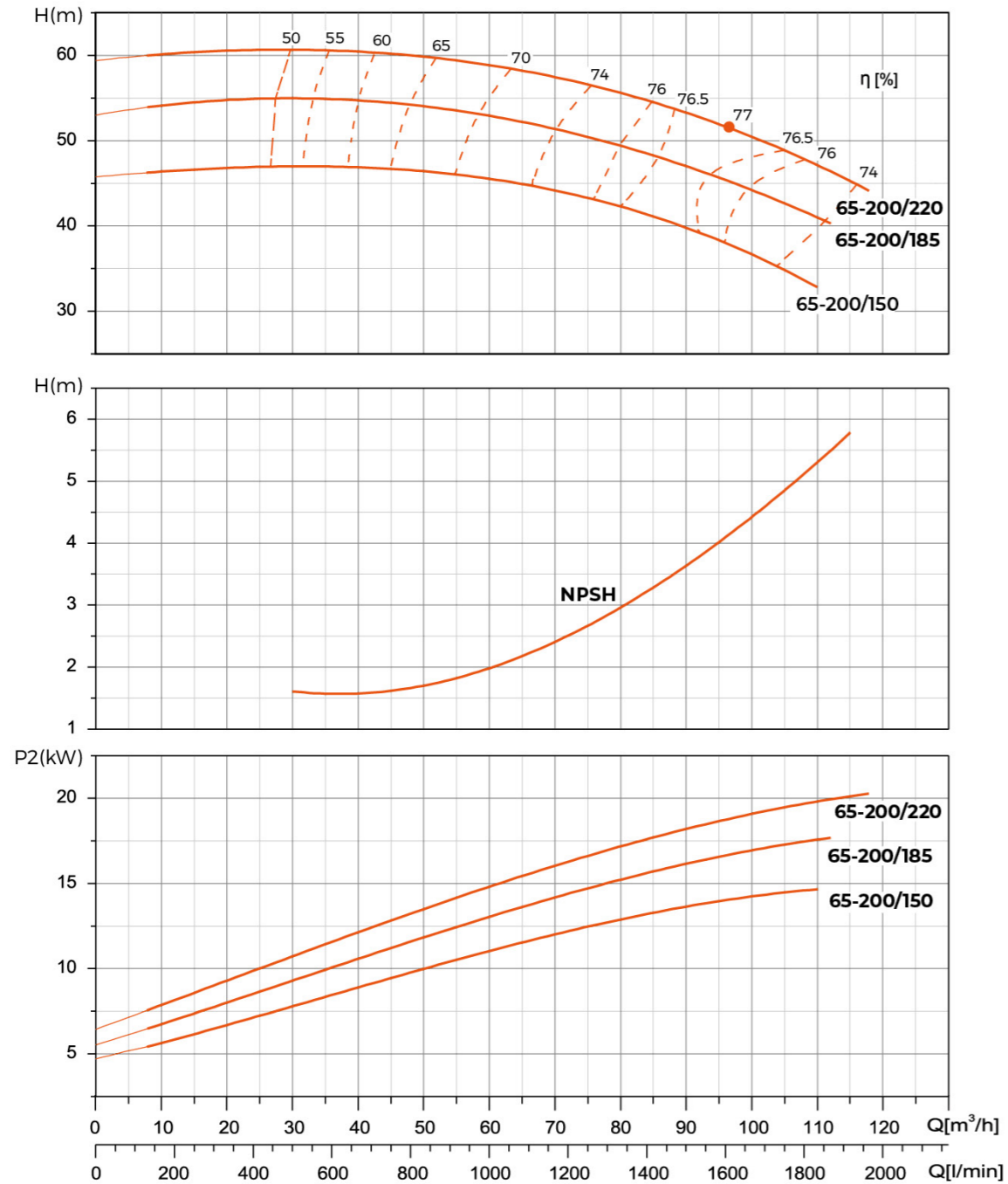

Hydraulic Performance Curves

XST65-200K	Rated speed: 2900r/min	ISO 9906 Annex A
------------	------------------------	------------------

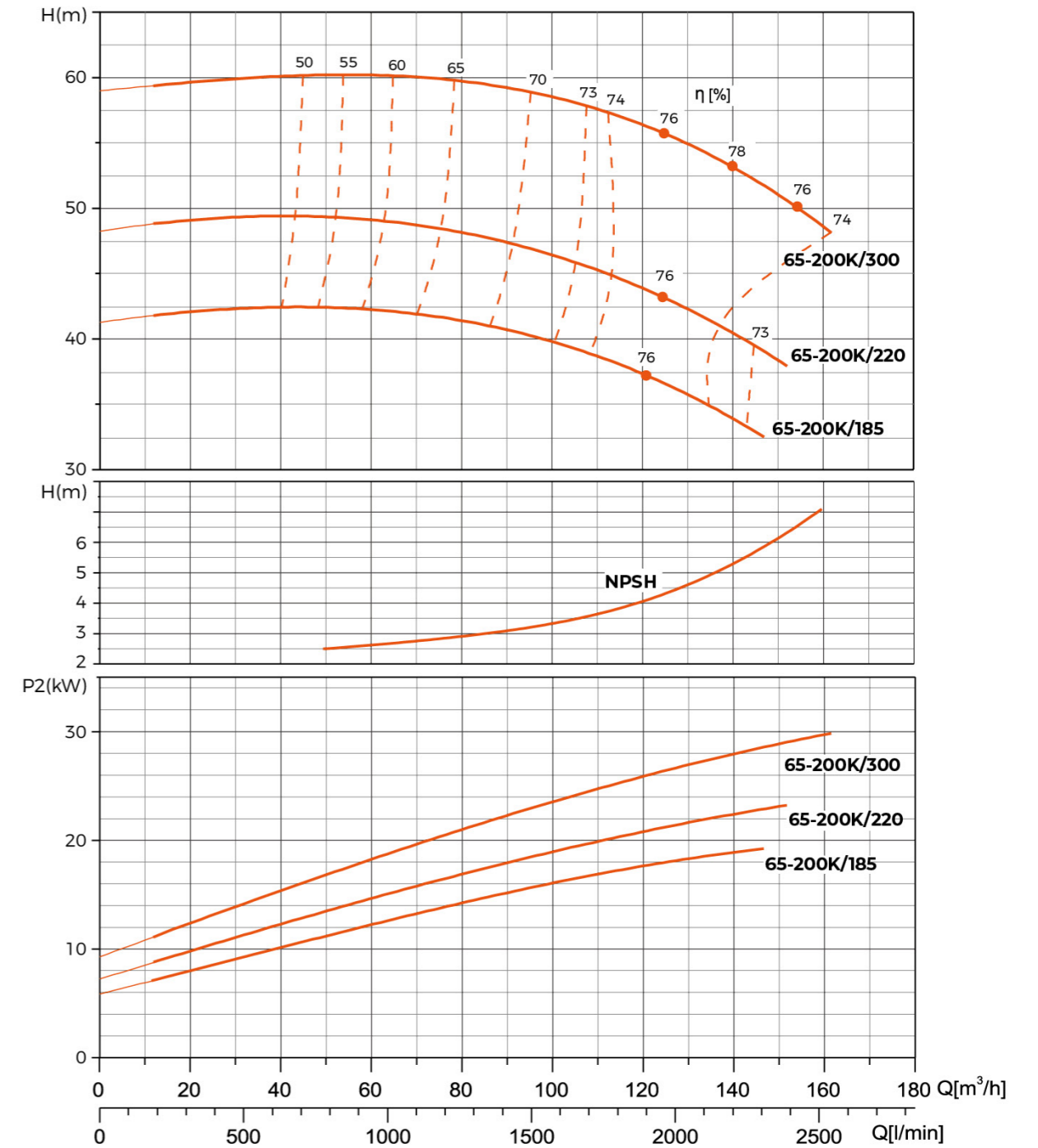

Hydraulic Performance Curves

XST65-250	Rated speed: 2900r/min	ISO 9906 Annex A
-----------	------------------------	------------------

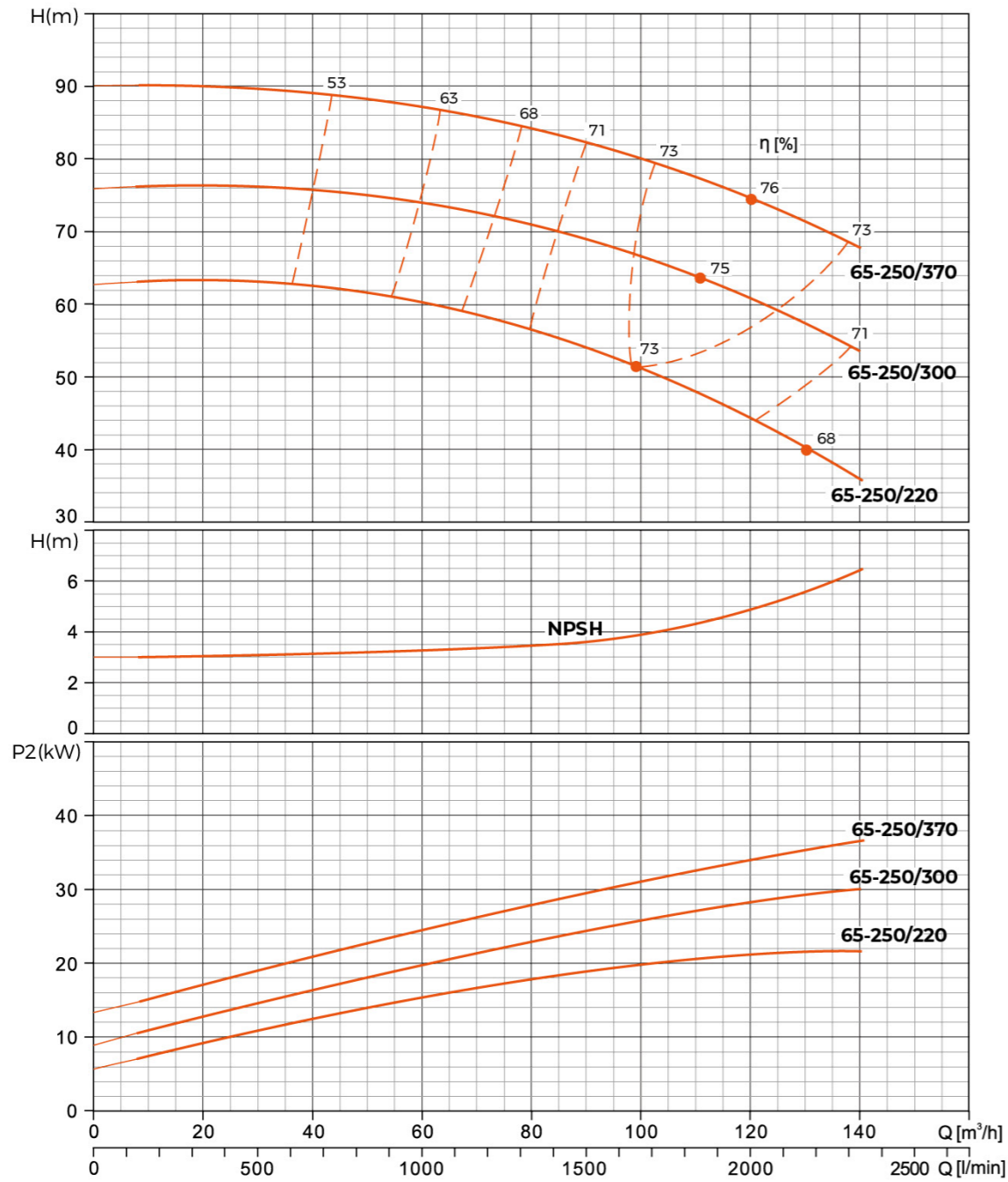

Hydraulic Performance Curves

XST80-160	Rated speed: 2900r/min	ISO 9906 Annex A
-----------	------------------------	------------------

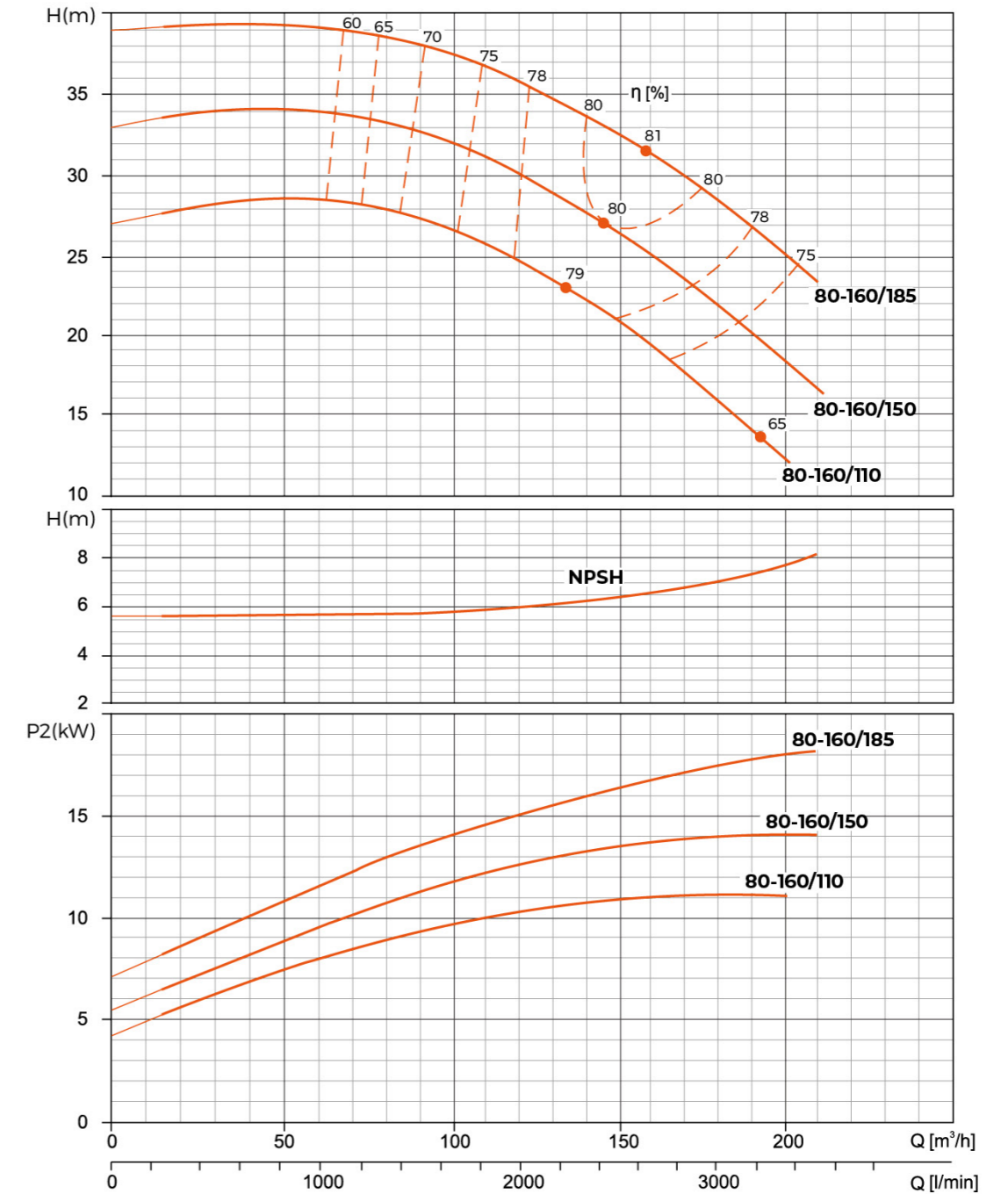

Hydraulic Performance Curves

XST80-200	Rated speed: 2900r/min	ISO 9906 Annex A
-----------	------------------------	------------------

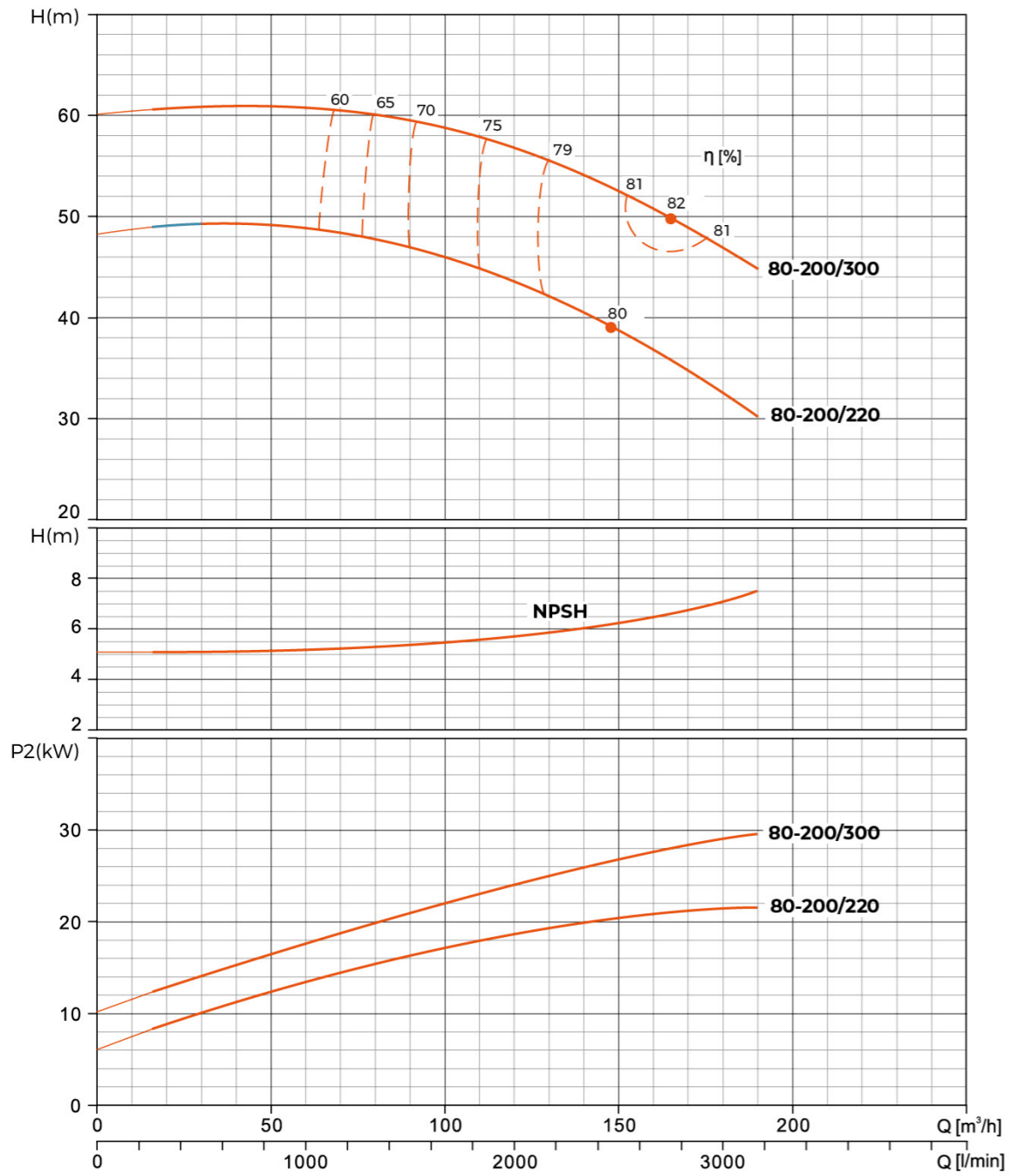

Hydraulic Performance Curves

XST80-250	Rated speed: 2900r/min	ISO 9906 Annex A
-----------	------------------------	------------------

