



AR 202 - AR 252

MEDIA PRESSIONE
medium pressure

Serie ANODIZZATA
anodised series

Kit Applicazioni pag. 98.
Application kits page 98.

Gruppi comando vedi pag. 112.
For control units please see page 112.



disinfestazione
pest control



carriole
wheelbarrows



antincendio
fire-fighting



AR 202 SP VRI

AR 252 SP SGC

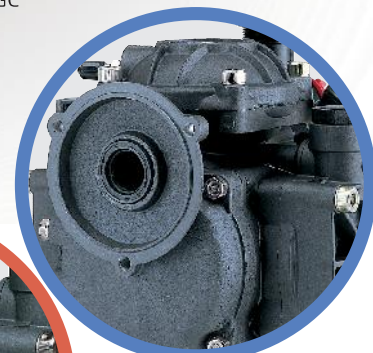

CR/XS



SP VRI



SP SGC



AP SP SGC

Caratteristiche Generali

Pompa a due membrane semidrauliche. Parti in contatto con i liquidi pompati in alluminio anodizzato e AISI 303/304. Membrane in NBR, Desmopan, Viton o **BlueFlex™**. Tenute in NBR. Viteria con trattamento di zincatura galvanica. Completa di camera aria.

General Features

Semi-hydraulic two-diaphragm pump. Parts in contact with pumped liquids in anodized aluminium and AISI 303/304. Diaphragms in NBR, Desmopan, Viton or **BlueFlex™**. Seals in NBR. Metal fasteners with galvanised finish. Complete with air chamber.

AR 202 SP VRI

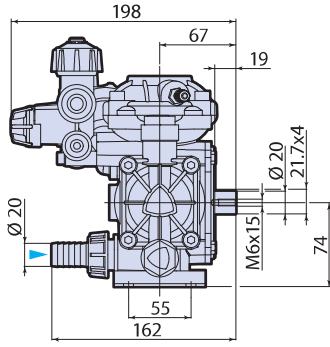

SP SGC

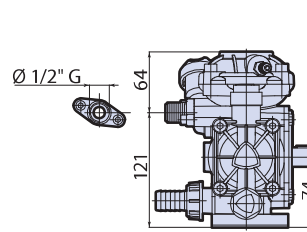

AR 252 SP VRI GR30

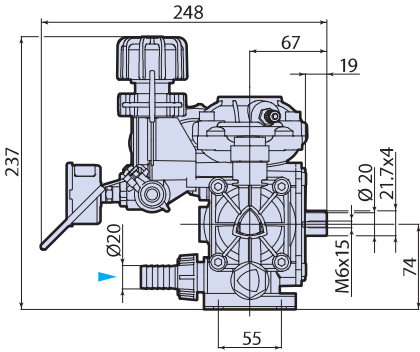

AP SP SGC

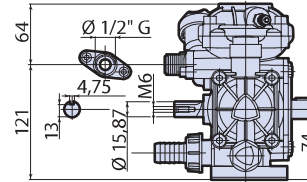

CR/xS

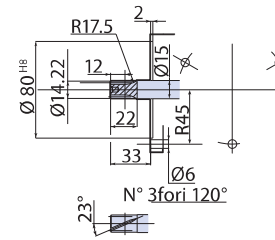

Dati dentatura elicoidale	
Mn	1,250
Mc	1,358
Z	8
Dp	11,73
De	14,22
Di	8,81
press.	20°
elica	23° sinistra
Wildab. 3Z	6,01 ^{+0,03}
Interasse	48,20
Rapp. Tras.	1:7,875

DI 8000260

MOD	COD			MAX	MAX	RPM	TEMP	NET				
	SP VRI	SP SGC	CR/xS	l/min	gpm	bar	psi	N° giri/1'	°C	°F	kg	lb
AR 202 NBR	153	157	163	23,2	6,1	20	290	650	60	140	4	8,8
AR 202 B	32090	32091	32092	23,2	6,1	20	290	650	60	140	4	8,8
AR 252 NBR	-	158	-	24,6	6,5	25	362	650	60	140	4	8,8
AR 252 B	-	32093	-	24,6	6,5	25	362	650	60	140	4	8,8
AR 252 AP NBR	-	159	-	24,6	6,5	25	362	650	60	140	4	8,8
AR 252 AP B	-	32094	-	24,6	6,5	25	362	650	60	140	4	8,8

B Pompa con Membrane in BlueFlex™
Pumps with BlueFlex™ diaphragm

NBR Pompa con Membrane in NBR
Pumps with NBR diaphragm

MAX	RPM												
	400			500			600			650			
bar	psi	l/min	gpm	HP	l/min	gpm	HP	l/min	gpm	HP	l/min	gpm	HP
AR 202													
0	0	15,0	4,0	0,09	18,1	4,8	0,13	21,7	5,7	0,19	23,2	6,1	0,21
5	72	11,8	3,1	0,23	14,7	3,9	0,30	17,7	4,7	0,38	19,2	5,1	0,39
10	145	11,3	3,0	0,36	14,2	3,8	0,47	17,1	4,5	0,55	18,5	4,9	0,59
15	218	11,2	3,0	0,50	14,1	3,7	0,62	16,9	4,5	0,74	18,3	4,8	0,80
20	290	11,1	2,9	0,60	14,0	3,7	0,79	16,8	4,4	0,93	18,2	4,8	1,02
AR 252													
0	0	16,0	4,2	0,13	20,5	5,4	0,19	23,1	6,1	0,21	24,6	6,5	0,24
5	72	13,5	3,6	0,30	17,3	4,6	0,38	20,8	5,5	0,46	22,2	5,9	0,46
10	145	13,2	3,5	0,44	16,6	4,4	0,58	19,8	5,2	0,64	21,3	5,6	0,71
15	218	13,1	3,5	0,58	16,4	4,3	0,76	19,6	5,2	0,89	21,2	5,6	0,98
20	290	13,0	3,4	0,72	16,3	4,3	0,94	19,5	5,2	1,11	21,0	5,6	1,21
25	362	12,9	3,4	0,87	16,2	4,3	1,10	19,3	5,1	1,33	20,9	5,5	1,42

Kit Appl. C cod.1488

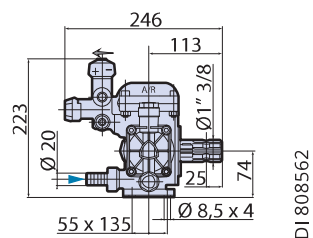
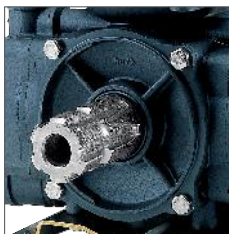

AR202 - AR252
Cardano 1" $\frac{3}{8}$ " · 1" $\frac{3}{8}$ " universal shaft

Kit Appl.P cod.1500

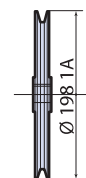
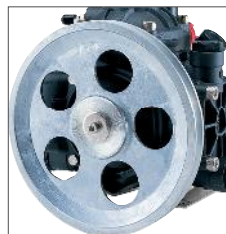

AR202 - AR252
Puleggia 1A ø198mm
Pulley 1A ø198mm

Kit Appl.FM/FT (1)

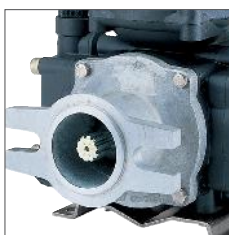

AR202 - AR252
Vedi listino prezzi · See price-list

Per motocoltivatori, motozappe,
trattori
*For motor-cultivators, motor-hoes,
tractors.*

Kit Appl. IDM (1)

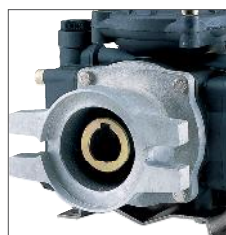

ARDUE < AR252
Codice vedi pag. 186
Code see page 186

Per motori idraulici
For hydraulic motors

I codici si riferiscono al solo kit applicazione, pompa esclusa.
(1) Le dimensioni di questi kit applicazione variano a secondo della marca e del tipo di macchina a cui deve essere applicata la pompa.

The part numbers refer to the application kit only, excluding the pump.
(1) *The dimensions of these kits vary according to the make and type of machine the pump is to be installed on.*

Le applicazioni sono da utilizzare solamente con le opportune protezioni a tutela dell'operatore.

The applications should be used only with the proper protective equipment for the safety of the operator.

application kits



CR 1:4,6
cod.1606

ARDUE
Riduttore per motori scoppio 2 tempi speciali, con base motore.
Reduction gear for special two-stroke engines, with motor base.

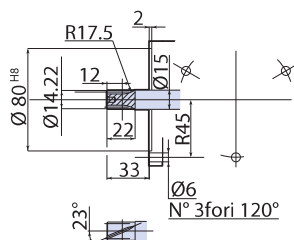

Dati dentatura elicoidale	
Mn	1,250
Mc	1,358
Z	8
Dp	11,73
De	14,22
Di	8,81
∠ press.	20°
∠ elica	23° sinistra
Wildab. 3Z	6,01 ⁰ _{-0,03}
Interasse	48,20
Rapp. Tras.	1:7,875

DI 800260

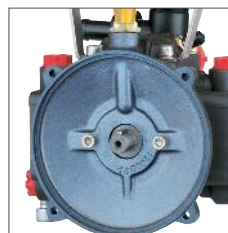

FLANGIA - FLANGE
cod.1603

ARDUE
Flangia accoppiamento diretto con motori elettrici monofase-trifase speciali 4 poli 1450 rpm.
Direct coupling flange with special four-pole single/three-phase electric motors 1450 rpm).

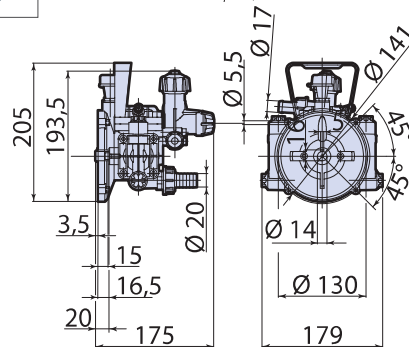

CM 808632



CR 1:7,8
cod.1610

AR202 - AR252
Riduttore per motori scoppio 2 tempi speciali, con base motore.
Reduction gear for special two-stroke engines, with motor base.

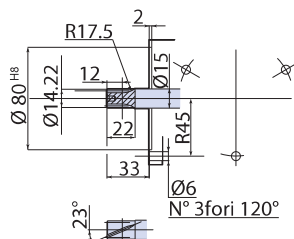

Dati dentatura elicoidale	
Mn	1,250
Mc	1,358
Z	8
Dp	11,73
De	14,22
Di	8,81
∠ press.	20°
∠ elica	23° sinistra
Wildab. 3Z	6,01 ⁰ _{-0,03}
Interasse	48,20
Rapp. Tras.	1:7,875

DI 800260

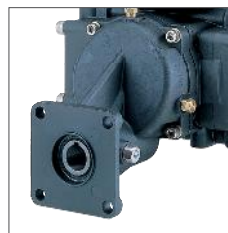

CR 1:4,3 Ø 5/8" cod.1615
CR 1:4,3 Ø 18mm cod.1618
CR 1:6 Ø 15mm cod.1622
CR 1:6 Ø 5/8" cod.1617
CR 1:4,3 Ø 3/4" cod.1613

AR202 - AR252
Riduttori motori a scoppio 4 tempi, flangia SAE J609a.
Reduction gears for four-stroke engines, SAE J609a flange

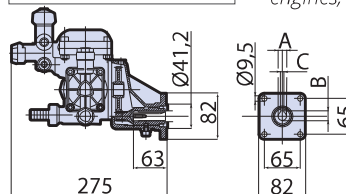

Cod.	1615	1618	1622	1617	1613
Ratio	1:4,3	1:4,3	1:6	1:6	1:4,3
A	Ø15,86	Ø18	Ø15	Ø15,86	Ø19,05
B	18,2	20,5	17,5	18,2	21,4
C	4,8	5	5	4,8	4,8

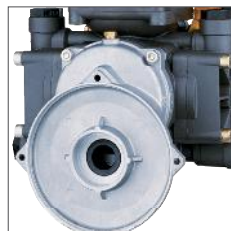

CR 1:4,3
cod.1608

AR202 - AR252
Riduttore motori elettrici speciali mono/trifase 2poli (2800 rpm)
Reduction gear for special two-stroke engines, with motor base (2800 rpm).

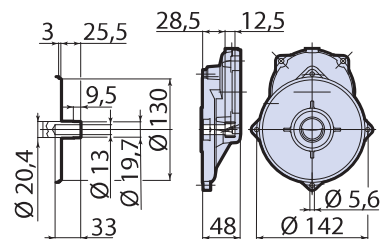

CR 1:7,8 Ø 15mm cod.1605

AR202 - AR252
Riduttore 1:7,8 per motori a scoppio cilindrico
1:7,8 reduction gear for special four-stroke engines with motor base

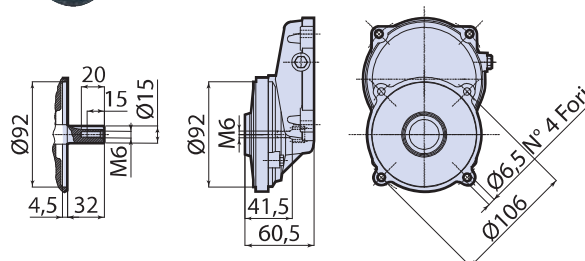

DI 808569
CM 808632