



# Technical data

Date	2/18/2025
Offer N.	---
Pump Type	CA50-200B

Client	UAB Vandens siurbliai	Reference	---
--------	-----------------------	-----------	-----

Pump data	
Pump body and rear shield	Cast iron GJL-250
Impeller	Cast iron GJL-250 On request bronze or stainless steel AISI 316
Pump bearings support	Cast iron GJL-250
Type of seal	Mechanical ceramic-graphite On request: gland packing graphite
Pump shaft end	Stainless steel AISI 316 EN X5CrNiMo17-12-2
Liquid temperature	-10°C +90°C
Operating pressure	Max 10 bar

Bare-shaft centrifugal pumps manufactured in accordance with EN 733 and widely used in water supply, pressure boosting and fire fighting systems. The pumps are equipped with counter flanges and can be provided with the motor assembled on a common base frame. In the standard version the pumps have cast iron impeller and mechanical seal. On request are available bronze or stainless steel AISI316 impeller and gland packing seal. In the "X" version all the wet parts of the pump are made of AISI 316.

P2	Motor Size	Q (m3/h - l/min)													
		0	24	27	30	33	36	39	42	45	48	54	60	66	72
(kW)		0	400	450	500	550	600	650	700	750	800	900	1000	1100	1200
		H (m)													
11	160M	53.1	54.6	54.1	53.5	52.9	52.2	51.4	50.4	49.3	48.1	45.5	42.7	38.8	35

## Technical Sheet

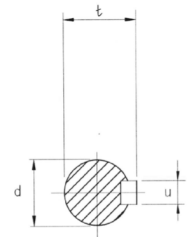
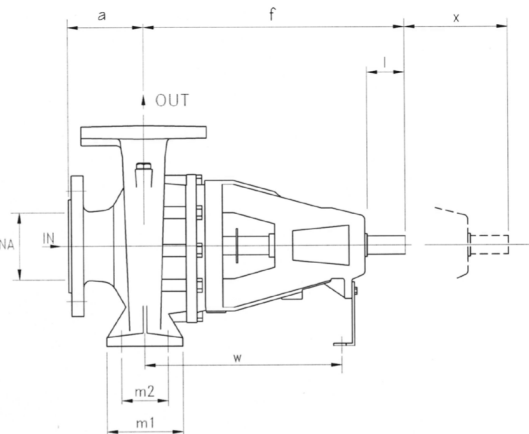
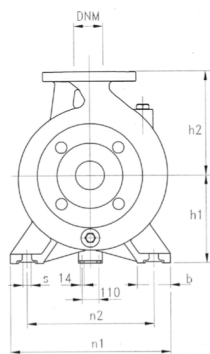
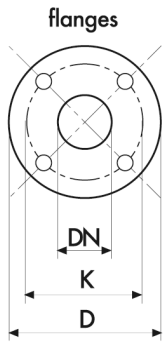

DN	D	K	holes	
			n°	Ø
32	140	100	4	18
40	150	110	4	18
50	165	125	4	18
65	185	145	4	18
80	200	160	8	18
100	220	180	8	18
125	250	210	8	18

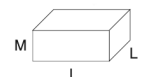

DNA	DNM	DIMENSIONS (mm)																		Kg	
		a	f	h1	h2	m1	m2	n1	n2	s	b	l	d	t	u	x	w	l	L		M
65	50	100	360	160	200	100	70	265	215	14	50	50	24	27	8	100	260	535	320	445	47

### Notes

The information may be subject to change without notice. It is always advisable to contact our commercial department in order to get further information about the products, their technical specifications and warranty conditions. The Company is expressly relieved of any liability for the purchasing of a product not in line with the customer's needs, if not consulted beforehand for a specific consultancy.



### Working Curves

Pump type: CA50-200B

Curv n°:	CA50-200B
Date:	2/18/2025
Pump Speed	2900 rpm

Q (m<sup>3</sup>/h) 55 | H (m) 42 | Power [kW] 9.85 | Efficiency % 67.73 | NPSH (m) 4.2

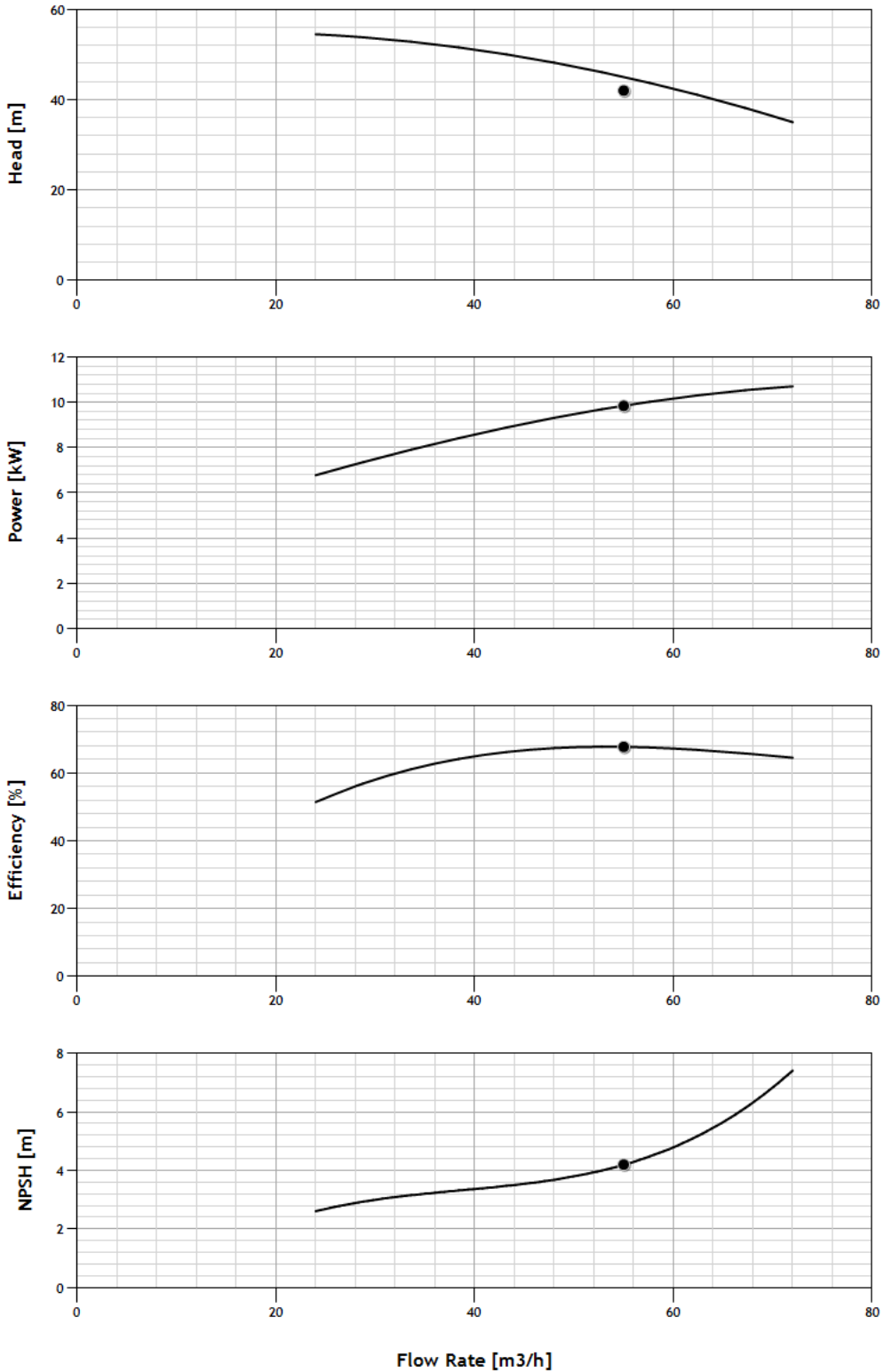

MEI ≥ 0,4 (regulation EU N. 547/2012)  
Tolerances according to UNI ISO 9906 grade 3B

# CA-4CA Series

## Models list and materials

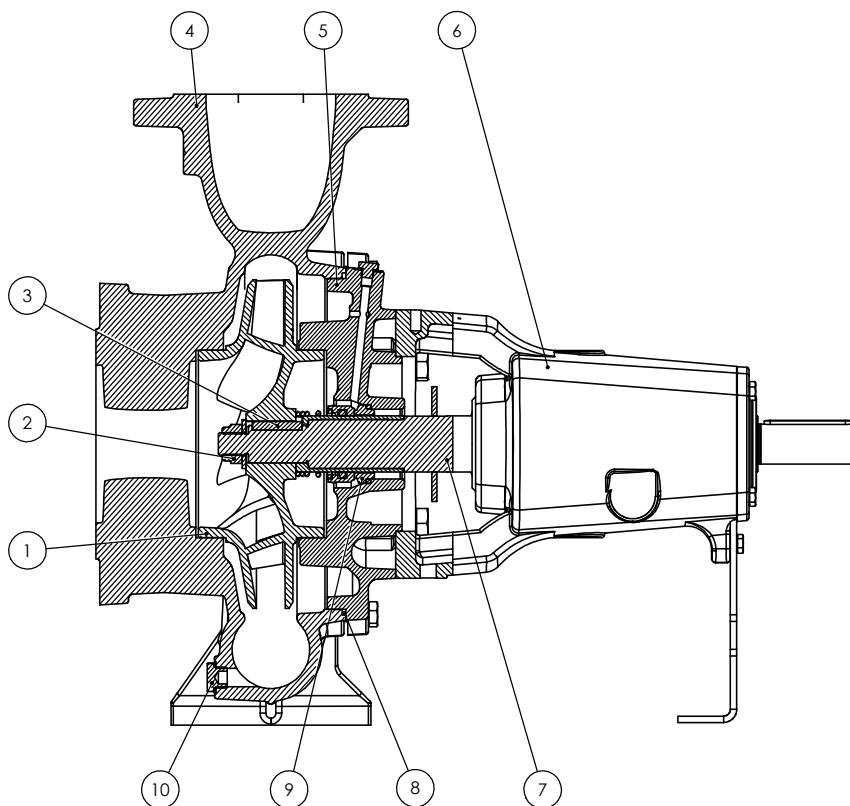

POS. N.	DENOMINATION	VERSION	MATERIAL	REFERENCE STANDARDS	
				EUROPE	USA
1	<b>Impeller</b>	Standard	Cast iron G20	GJL-200 (JL1030)	ASTM Class 30
		B	Bronze	CuSn10-C (CC480K)	UNS C90700
		X	Stainless steel	X5CrNiMo17-12-2/ 1.4401	AISI 316
2	<b>Impeller lock nut and washer</b>		Stainless steel	X5CrNiMo17-12-2/ 1.4401	AISI 316
3	<b>Impeller key</b>		Stainless steel	X5CrNiMo17-12-2/ 1.4401	AISI 316
4	<b>Volute casing</b>	Standard for models up to 80-200	Cast iron G20	GJL-200 (JL1030)	ASTM Class 30
		Standard from model 80-250	Cast iron G25	GJL-250 (JL1040)	ASTM Class 35
		X	Stainless steel	X5CrNiMo17-12-2/ 1.4401	AISI 316
5	<b>Casing cover</b>	Standard	Cast iron G20	GJL-200 (JL1030)	ASTM Class 30
		X	Stainless steel	X5CrNiMo17-12-2/ 1.4401	AISI 316
6	<b>Bracket</b>		Cast iron G20	GJL-200 (JL1030)	ASTM Class 30
7	<b>Shaft</b>		Stainless steel	X5CrNiMo17-12-2/ 1.4401	AISI 316
8	<b>O-ring</b>	Standard	NBR		
		E	EPDM		
		V	FKM		
9	<b>Mechanical seal</b>		(Search for the material in the mechanical seal table)		
10	<b>Fill and drain plugs</b>	Standard	Brass	CU ZN 40 PB2 UNI 5705/65	C37700
		X	Stainless steel	X5CrNiMo17-12-2/ 1.4401	AISI 316

MECHANICAL SEAL	PUMP MODEL	SHAFT Ø		STANDARD MATERIAL	OPTIONAL			
	CA32-160C, CA32-160B, CA32-160A, CA40-125C, CA40-125B, CA40-125A	20mm	<b>Rotating face</b> <b>Stationary face</b> <b>Elastomer</b>	Ceramic Graphite NBR	Ceramic Graphite EPDM	- - -	SiC SiC EPDM	SiC SiC FKM
	CA40-250BM, CA40-250AM	28mm	<b>Rotating face</b> <b>Stationary face</b> <b>Elastomer</b>	Ceramic Graphite EPDM	- - -	- - -	SiC SiC EPDM	SiC SiC FKM
	CA32-200C, CA32-200B, CA32-200A, CA32-250C, CA32-250B, CA32-250A, CA40-160B, CA40-160A, CA40-200B, CA40-200A, CA40-250C, CA40-250B, CA40-250A, CA50-125B, CA50-125A, CA50-160B, CA50-160A, CA50-200C, CA50-200B, CA50-200A, CA50-250C, CA50-250B, CA50-250A, CA65-125B, CA65-125A, CA65-160C, CA65-160B, CA65-160A, CA65-200C, CA65-200B, CA65-200A, CA80-160E, CA80-160D, CA80-160C, CA80-160B, CA80-160A	28mm	<b>Rotating face</b> <b>Stationary face</b> <b>Elastomer</b>	Ceramic Graphite NBR	Ceramic Graphite EPDM	Ceramic Graphite FKM	SiC SiC EPDM	SiC SiC FKM
	4CA50-315C, 4CA50-315B, 4CA50-315A, CA65-250B, CA65-250A, 4CA65-315CM, 4CA65-315BM, 4CA65-315AM, CA80-200B, CA80-200A, 4CA80-315B, 4CA80-315A, 4CA100-315	40mm	<b>Rotating face</b> <b>Stationary face</b> <b>Elastomer</b>	CrNi-steel Graphite NBR	CrNi-steel Graphite EPDM	CrNi-steel Graphite FKM	SiC SiC EPDM	SiC SiC FKM
	CA50-315DN, CA50-315CN, CA50-315BN, CA50-315AN, CA65-315CN, CA65-315BN, CA65-315AN, CA80-315BN, CA80-315AN	40mm	<b>Rotating face</b> <b>Stationary face</b> <b>Elastomer</b>	SiC SiC EPDM	- - -	- - -	- - -	SiC SiC FKM
	CA80-250B, CA80-250A, CA100-200B, CA100-200A, CA100-250C, CA100-250B, CA100-250A, 4CA100-250E, 4CA125-250B, 4CA125-250A	45mm	<b>Rotating face</b> <b>Stationary face</b> <b>Elastomer</b>	CrNi-steel Graphite NBR	CrNi-steel Graphite EPDM	CrNi-steel Graphite FKM	SiC SiC EPDM	SiC SiC FKM
	4CA100-400C, 4CA100-400B, 4CA100-400A, 4CA125-315C, 4CA125-315B, 4CA125-315A, 4CA125-400C, 4CA125-400B, 4CA125-400A, 4CA150-315C, 4CA150-315B, 4CA150-315A, 4CA150-400B, 4CA150-400A	55mm	<b>Rotating face</b> <b>Stationary face</b> <b>Elastomer</b>	Graphite SiC FKM	- - -	- - -	SiC SiC EPDM	SiC SiC FKM
	4CA200-315D, 4CA200-315C, 4CA200-315B, 4CA200-315A, 4CA200-400C, 4CA200-400B, 4CA200-400A, 4CA250-315C, 4CA250-315B, 4CA250-315A, 4CA250-400D, 4CA250-400C, 4CA250-400B, 4CA250-400A	70mm	<b>Rotating face</b> <b>Stationary face</b> <b>Elastomer</b>	Graphite SiC FKM	- - -	- - -	SiC SiC EPDM	SiC SiC FKM

PUMP BEARINGS	PUMP MODEL	TYPE	
	CA32-160C, CA32-160B, CA32-160A, CA32-200C, CA32-200B, CA32-200A, CA32-250C, CA32-250B, CA32-250A, CA40-125C, CA40-125B, CA40-125A, CA40-160B, CA40-160A, CA40-200B, CA40-200A, CA40-250C, CA40-250B, CA40-250A, CA40-250BM, CA40-250AM, CA50-125B, CA50-125A, CA50-160B, CA50-160A, CA50-200C, CA50-200B, CA50-200A, CA50-250C, CA50-250B, CA50-250A, CA65-125B, CA65-125A, CA65-160C, CA65-160B, CA65-160A, CA65-200C, CA65-200B, CA65-200A, CA80-160E, CA80-160D, CA80-160C, CA80-160B, CA80-160A	6306-ZZ C3	6306-ZZ C3
	4CA50-315, CA65-250B, CA65-250A, 4CA65-315CM, 4CA65-315BM, 4CA65-315AM, CA80-200B, CA80-200A, 4CA80-315B, 4CA80-315A, 4CA100-315C, 4CA100-315B, 4CA100-315A	3208-ZZ C3	3208-ZZ C3
	CA50-315DN, CA50-315CN, CA50-315BN, CA50-315AN, CA65-315CN, CA65-315BN, CA65-315AN, CA80-250B, CA80-250A, CA80-315BN, CA80-315AN, CA100-200B, CA100-200A, CA100-250C, CA100-250B, CA100-250A, 4CA100-250E, 4CA125-250B, 4CA125-250A	6209-ZZ C3	6309-ZZ C3
	4CA100-400C, 4CA100-400B, 4CA100-400A, 4CA125-315C, 4CA125-315B, 4CA125-315A, 4CA125-400C, 4CA125-400B, 4CA125-400A, 4CA150-315C, 4CA150-315B, 4CA150-315A, 4CA150-400A, 4CA150-400B	6211-ZZ C3	6311-ZZ C3
	4CA200-315D, 4CA200-315C, 4CA200-315B, 4CA200-315A, 4CA200-400C, 4CA200-400B, 4CA200-400A, 4CA250-315C, 4CA250-315B, 4CA250-315A, 4CA250-400D, 4CA250-400C, 4CA250-400B, 4CA250-400A	6313-ZZ C3	6313-ZZ C3

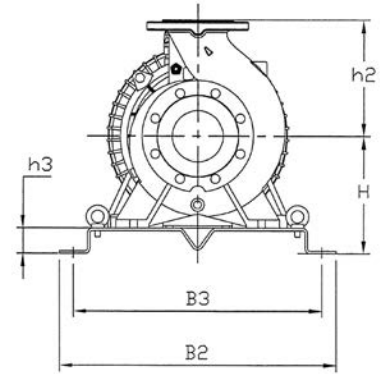
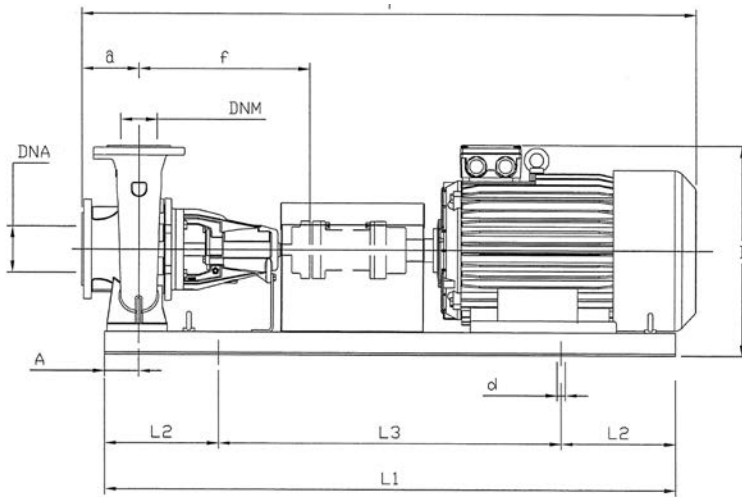

TYPE	kW	Motor Size	DIMENSIONS (mm)																Kg
			DNA	DNM	a	f	H	h2	h3	L1	L2	L3	B2	B3	A	d	T	I	
32-160C	1,5	90S	50	32	80	360	182	160	50	900	150	600	390	350	60	18	855	342	82,1
32-160B	2,2	90L			80	360	182	160	50	900	150	600	390	350	60	18	920	342	87,7
32-160A	3	100L			80	360	182	160	50	900	150	600	390	350	60	18	920	362	96,7
32-160A	4	112M			80	360	182	160	50	900	150	600	390	350	60	18	940	375	104,7
32-200C	4	112M			80	360	210	180	50	900	150	600	390	350	60	18	940	403	108,7
32-200B	5,5	132S			80	360	210	180	50	1000	170	660	450	400	60	22	1020	433	116,1
32-200A	7,5	132S			80	360	210	180	50	1000	170	660	450	400	60	22	1020	433	144,3
32-250C	11	160M			100	360	230	225	50	1250	205	840	540	490	75	22	1275	495	207,3
32-250B	11	160M			100	360	230	225	50	1250	205	840	540	490	75	22	1275	495	207,3
32-250A	15	160M	100	360	230	225	50	1250	205	840	540	490	75	22	1275	495	219,3		
40-125C	1,5	90S	65	40	80	360	162	140	50	900	150	600	390	350	60	18	855	317	82,2
40-125C	2,2	90L			80	360	162	140	50	900	150	600	390	350	60	18	920	317	87,8
40-125B	2,2	90L			80	360	162	140	50	900	150	600	390	350	60	18	920	317	87,8
40-125B	3	100L			80	360	162	140	50	900	150	600	390	350	60	18	920	342	96,8
40-125A	3	100L			80	360	162	140	50	900	150	600	390	350	60	18	920	342	96,8
40-160B	3	100L			80	360	182	160	50	900	150	600	390	350	60	18	920	362	99,8
40-160B	4	112M			80	360	182	160	50	900	150	600	390	350	60	18	940	375	107,8
40-160A	4	112M			80	360	182	160	50	900	150	600	390	350	60	18	940	375	107,8
40-160A	5,5	132S			80	360	182	160	50	1000	170	660	450	400	60	22	1020	405	115,2
40-160AP	5,5	132S			80	360	182	160	50	1000	170	660	450	400	60	22	1020	405	115,2
40-200B	5,5	132S			100	360	210	180	50	1000	170	660	450	400	60	22	1040	433	119,2
40-200B	7,5	132S			100	360	210	180	50	1000	170	660	450	400	60	22	1040	433	147,4
40-200A	7,5	132S			100	360	210	180	50	1000	170	660	450	400	60	22	1040	433	147,4
40-200A	11	160M			100	360	210	180	50	1120	190	740	490	440	60	22	1168	475	198,4
40-200 AP	7,5	132S			100	360	210	180	50	1000	170	660	450	400	60	22	1040	433	147,4
40-200 AP	11	160M			100	360	210	180	50	1120	190	740	490	440	60	22	1168	475	198,4
40-250C	11	160M			100	360	230	225	50	1250	205	840	540	490	75	22	1275	495	208,9
40-250B	11	160M			100	360	230	225	50	1250	205	840	540	490	75	22	1275	495	208,9
40-250B	15	160M			100	360	230	225	50	1250	205	840	540	490	75	22	1275	495	220,9
40-250A	15	160M			100	360	230	225	50	1250	205	840	540	490	75	22	1275	495	220,9
40-250A	18,5	160L			100	360	230	225	50	1250	205	840	540	490	75	22	1275	495	238,9
40-250BM	18,5	160L			100	360	230	225	50	1250	205	840	540	490	75	22	1275	495	238,9
40-250AM	22	180M			100	360	230	225	50	1250	205	840	540	490	75	22	1275	510	297,3
50-125B	3	100L			65	50	100	360	182	160	50	900	150	600	390	350	60	18	940
50-125A	4	112M	100	360			182	160	50	900	150	600	390	350	60	18	960	375	107,7
50-160B	5,5	132S	100	360			210	180	50	1000	170	660	450	400	60	22	1040	433	119,6
50-160A	7,5	132S	100	360			210	180	50	1000	170	660	450	400	60	22	1040	433	147,8
50-200C	11	160M	100	360			210	200	50	1120	190	740	490	440	60	22	1168	475	201,8
50-200B	11	160M	100	360			210	200	50	1120	190	740	490	440	60	22	1168	475	201,8
50-200A	15	160M	100	360			210	200	50	1120	190	740	490	440	60	22	1168	475	213,8
50-250C	15	160M	100	360			230	225	50	1250	205	840	540	490	75	22	1275	495	224,8
50-250B	18,5	160L	100	360			230	225	50	1250	205	840	540	490	75	22	1275	495	242,8
50-250A	22	180M	100	360			230	225	50	1250	205	840	540	490	75	22	1275	510	301,2
50-315DN	37	200L	125	470			275	280	50	1400	230	940	610	550	75	26	1455	585	415,0
50-315CN	45	225M	125	470			275	280	50	1400	230	940	610	550	75	26	1500	605	465,8
50-315BN	55	250M	125	470	310	280	85	1600	270	1060	660	600	75	26	1650	710	611,8		
50-315AN	75	280S	125	470	310	280	85	1800	300	1200	730	670	75	26	1850	770	762,6		

TYPE	kW	Motor Size	DIMENSIONS (mm)																Kg
			DNA	DNM	a	f	H	h2	h3	L1	L2	L3	B2	B3	A	d	T	I	
65-125B	5,5	132S	80	65	100	360	210	180	50	1000	170	660	450	400	60	22	1040	433	121,4
65-125A	7,5	132S			100	360	210	180	50	1000	170	660	450	400	60	22	1040	433	149,6
65-160C	11	160M			100	360	210	200	50	1120	190	740	490	440	60	22	1168	475	205,1
65-160B	11	160M			100	360	210	200	50	1120	190	740	490	440	60	22	1168	475	205,1
65-160A	15	160M			100	360	210	200	50	1120	190	740	490	440	60	22	1168	475	217,1
65-200C	15	160M			100	360	230	225	50	1250	205	840	540	490	75	22	1275	495	227,5
65-200B	18,5	160L			100	360	230	225	50	1250	205	840	540	490	75	22	1275	495	245,5
65-200A	22	180M			100	360	230	225	50	1250	205	840	540	490	75	22	1290	510	303,3
65-250B	30	200L			100	470	250	250	50	1400	230	940	610	550	90	26	1470	560	377,8
65-250A	37	200L			100	470	250	250	50	1400	230	940	610	550	90	26	1470	560	397,8
65-315CN	55	250M			125	470	310	280	85	1600	270	1060	660	600	90	26	1645	710	614,2
65-315BN	75	280S			125	470	310	280	85	1800	300	1200	730	670	90	26	1835	770	765,0
65-315AN	90	280M	125	470	310	280	85	1800	300	1200	730	670	90	26	1835	770	839,2		
80-160E	11	160M	100	80	125	360	230	225	50	1250	205	840	540	490	75	22	1300	495	220,8
80-160D	11	160M			125	360	230	225	50	1250	205	840	540	490	75	22	1300	495	220,8
80-160C	15	160M			125	360	230	225	50	1250	205	840	540	490	75	22	1300	495	232,8
80-160B	18,5	160L			125	360	230	225	50	1250	205	840	540	490	75	22	1300	495	250,8
80-160A	22	180M			125	360	230	225	50	1250	205	840	540	490	75	22	1315	510	308,7
80-200B	30	200L			125	470	230	250	50	1400	230	940	610	550	75	26	1495	560	376,7
80-200A	37	200L			125	470	230	250	50	1400	230	940	610	550	75	26	1495	560	396,7
80-250B	45	225M			125	470	250	280	50	1400	230	940	610	550	90	26	1540	605	464,5
80-250A	55	250M			125	470	285	280	85	1600	270	1060	660	600	90	26	1645	710	610,5
80-315BN	90	280M			125	470	335	315	85	1800	300	1200	730	670	90	26	1835	770	850,5
80-315AN	110	315S			125	470	405	315	120	2000	300	1400	790	750	90	22	2020	925	1233
100-200B	45	225M			125	100	125	470	250	280	50	1400	230	940	610	550	90	26	1540
100-200A	55	250M	125	470			285	280	85	1600	270	1060	660	600	90	26	1645	710	617,5
100-250C	55	250M	140	470			310	280	85	1600	270	1060	660	600	90	26	1660	710	625,5
100-250C	75	280S	140	470			310	280	85	1800	300	1200	730	670	90	26	1850	770	776,3
100-250B	75	280S	140	470			310	280	85	1800	300	1200	730	670	90	26	1850	770	776,3
100-250A	90	280M	140	470			310	280	85	1800	300	1200	730	670	90	26	1850	770	850,5