

TECHNICAL DATA SHEET PHOENIX P250



PP



PVDF+CF



ALU



AISI 316

TECHNICAL DATA P250

- FLUID CONNECTIONS : 1 1/4" BSP
- AIR CONNECTION : 1/2" BSP
- MAX FLOW RATE : 250 lt/min
- MAX AIR PRESSURE: 8 bar
- MAX DELIVERY HEAD: 80 m
- MAX SUCTION LIFT DRY: 6 m
- MAX SUCTION LIFT WET: 9,8 m
- MAX SOLID PASSING: 7,5 mm
- NOISE LEVEL: 75 dB
- DISPLACEMENT FOR CYCLE: 330 cc
- MAX VISCOSITY : 35.000 cps
- ATEX zone 2 : EX II 3/3 GD c IIB T135°C

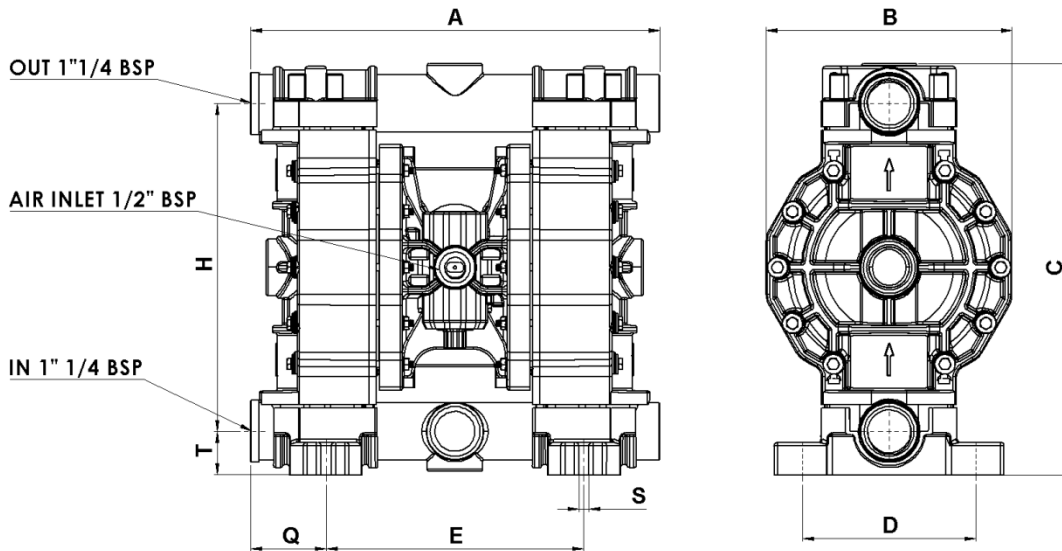
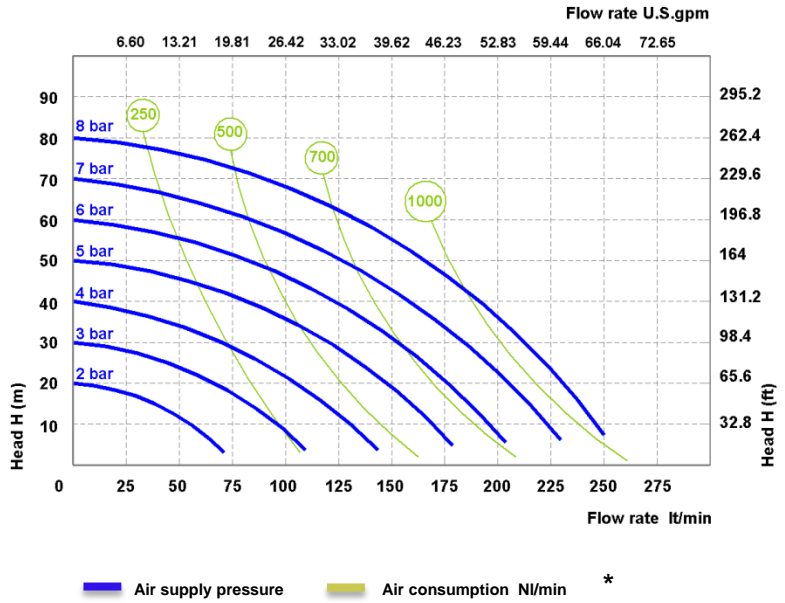

PHOENIX P250	A	B	C	D	E	H	Q	S	T	Weight Kg	Max Temperature
PP	370	222	372	157	233	296	69	9	39	15	65 °C
PVDF+CF	370	222	372	157	233	296	69	9	39	16	95 °C
ALU	370	222	364	157	233	286	69	9	39	16	95 °C
AISI 316	360	222	349	129	254	273	66	9	46	20	95 °C

* The curves and performance values refer to pumps with submerged suction and a free delivery outlet with water at 20°C, and vary according to the construction material. Technical data are approximate and not binding for the manufacturer who reserves the right to change them without notice at any time.

COMPOSITION

MODEL	CASING	DIAPHRAGM	BALL	SEATS	GASKET	CONNECTIONS	ATEX	PORTS IN/OUT
P0250	P= PP KC= PVDF+CF A= ALU S=SS	HT=HYTREL+PTFE MT=SANTOPRENE+PTFE H=HYTREL M=SANTOPRENE D=EPDM N=NBR	T= PTFE S= SS D=EPDM N=NBR	P=PP K=PVDF A=ALU S=SS Z=PE-UHMWE	D=EPDM V=VITON N=NBR T=PTFE	1=BSP 2=FLANGED 5=NPT	- = zone 2	AB=Standard

AVAILABLE CONNECTIONS

Standard = A B
 IN = A-E-T-C-G
 OUT =B-S-D-F-P

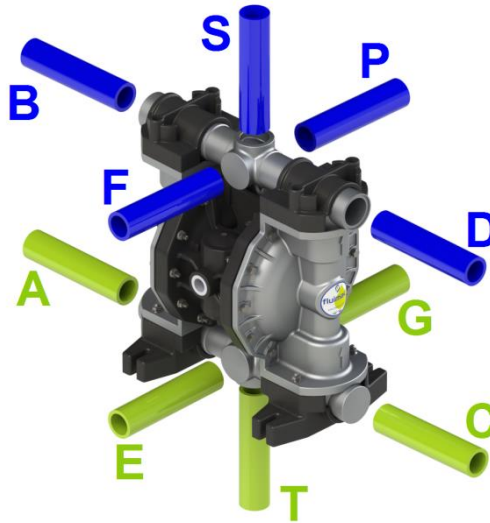

HOW TO READ THE CODE

