

## Product description



GR-110916

Grundfos PM PLUS is a pressure manager designed for automatic start/stop control of Grundfos or other pumps for water supply in domestic applications. With adjustable start pressure, PM PLUS can easily be customised to your specific application. PM PLUS features automatic protection that stops the pump in case of water shortage, preventing dry running. In case of temporary power outage, PM PLUS automatically resets itself once power is restored.

## Applications

Typical applications are water supply systems and rainwater systems in, for example:

- single-family houses
- blocks of flats
- summer houses and holiday cottages
- horticulture and gardening
- agriculture.

The product can be mounted in connection with a tank or directly on a pump.

## Liquids

Clean, thin, non-aggressive and non-explosive liquids without solid particles or fibres that may attack the unit mechanically or chemically.

Examples:

- municipal water
- rainwater.

## Approvals and markings

### Safety approvals



### Drinking water approvals



ACS

## Features

The product features the following:

- adjustable start pressure
- dry-running protection and automatic restart
- integrated non-return valve
- internal pressure membrane and tank
- suitable for generator operation
- pressure gauge, 0-12 bar (174 psi) range
- dual voltage (115-230 V)
- anti-jamming function.

## Operating panel

The product offers a user-friendly interface with a **Reset** button and indicator lights.

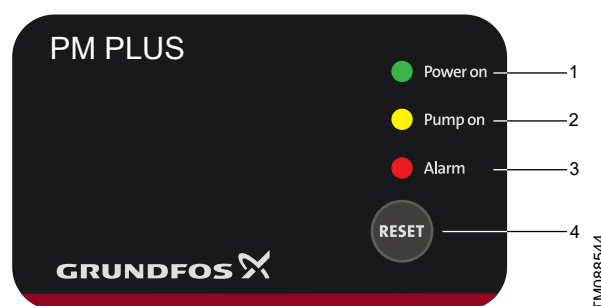

TM088544

| Pos. | Description     | Function  |
|------|-----------------|---|
| 1    | <b>Power on</b> | The green indicator light is permanently on when the power is on. |
| 2    | <b>Pump on</b>  | The yellow indicator light is on when the pump is in operation.   |
| 3    | <b>Alarm</b>    | The red indicator light flashes in case of dry running.           |
| 4    | <b>Reset</b>    | The button is used for resetting fault indications.               |

## Technical data

|                         |                                    |
|-------------------------|------------------------------------|
| Supply voltage          | 115/230 VAC, $\pm 10\%$ , 50/60 Hz |
| Ambient temperature     | 0-50 °C (122 °F)                   |
| Liquid temperature      | 0-60 °C (140 °F)                   |
| Max. current            | 10 A                               |
| Max. power at 115 VAC   | 0.75 kW (1 hp)                     |
| Max. power at 230 VAC   | 1.5 kW (2 hp)                      |
| Enclosure class         | IP 65                              |
| Max. operating pressure | 12 bar (174 psi)                   |
| Min. flow rate          | $\approx 1$ l/min (0.26 gpm)       |
| Pumped liquids          | Clean water                        |
| Connection type         | G1/NPT                             |

## Quick sizing

The below sizing table can help you determine which cut-in pressure suits your application requirements.

|                        |                     |                   |                     |                    |
|------------------------|---------------------|-------------------|---------------------|--------------------|
| Cut-in pressure        | 1.5 bar<br>(22 psi) | 2 bar<br>(29 psi) | 2.5 bar<br>(36 psi) | 3 bar<br>(44 psi)  |
| Number of floors       | 5                   | 6                 | 8                   | 10                 |
| Building height<br>(H) | 15 m<br>(49 ft)     | 25 m<br>(82 ft)   | 30 m<br>(98.4 ft)   | 35 m<br>(114.8 ft) |
| Min. pump<br>pressure  | 3<br>(44 psi)       | 3.5<br>(51 psi)   | 4<br>(58 psi)       | 4.5<br>(65 psi)    |

## Related information

[Installation example](#)

## Dimensional drawing

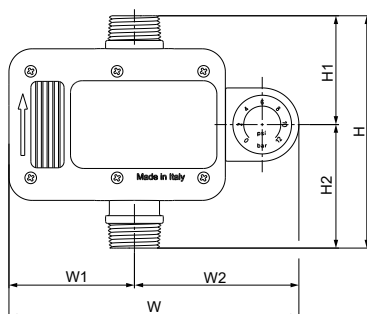

## Installation example

The pressure manager can be installed in systems with or without a pressure tank. It can be fitted directly to the outlet port of the pump or between the pump and the first draw-off point.

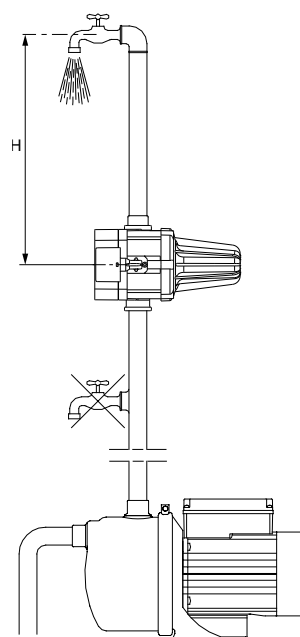

## Related information

[Quick sizing](#)

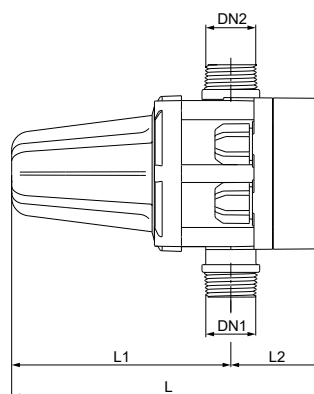

| Product | Dimensions   |              |              |              |              |              |              |              |              |          |
|---------|--------------|--------------|--------------|--------------|--------------|--------------|--------------|--------------|--------------|----------|
|         | L            | L1           | L2           | W            | W1           | W2           | H            | H1           | H2           | DN1, DN2 |
|         | mm<br>[inch] | mm<br>[inch] | mm<br>[inch] | mm<br>[inch] | mm<br>[inch] | mm<br>[inch] | mm<br>[inch] | mm<br>[inch] | mm<br>[inch] | [inch]   |
| PM PLUS | 200<br>[7.9] | 140<br>[5.5] | 60<br>[2.4]  | 188<br>[7.4] | 81<br>[3.2]  | 107<br>[4.2] | 150<br>[5.9] | 70<br>[2.8]  | 80<br>[3.1]  | G1       |

93303895 01.2025

ECM: 1410726

GRUNDFOS Holding A/S  
Poul Due Jensens Vej 7  
DK-8850 Bjerringbro  
Tel: +45 87 50 14 00  
www.grundfos.com

**GRUNDFOS**

TM089107

TM088432